

DESCRIPTION

Solenoid valve 2 way normally closed
direct acting poppet type, suitable for
food applications and all compatible fluids.

CONSTRUCTION

Body	Thermoplastic polymer
Armature tube	ACS, KTW, W270, WRAS, NSF, FDA certified
Plunger and core	Brass chemically nickel plated
Springs	AISI 430FR
Seal material	AISI 302
	NBR - FPM - EPDM



2

FEATURES

Maximum allowable pressure PS 30bar^⑤
Maximum fluid viscosity 25cSt (mm²/s)
Ambient temperature: from -10°C to +80°C according to the coil
Universal mounting position

OPTIONS: Stainless steel armature tube
Type N connection without nut
c  us certified coils

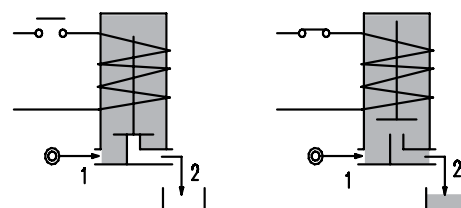
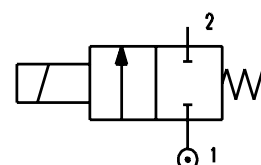

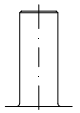
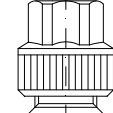
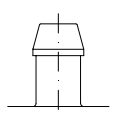
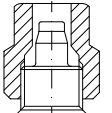
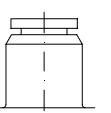
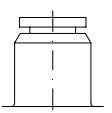
CONNECTION					
K	N	P	W ④	Y	Z
					
SPIGGOT	G1/8" male thread with NUT for flexible pipes	HOSETAIL for flexible pipes	COMPRESSION for flexible and semiflexible pipes	PUSH IN for semiflexible pipes Øext 6	PUSH IN for semiflexible pipes Øext 4

CODE ① ② ③	Connection ①	Orifice mm	Kv m ³ /h	Differential pressure bar			Nominal power			Coil		Seal ②	Temp. range **
				Min	Max		AC	VA	DC	Series	Width		
E135... ..15///...	K-N-P-W-Y-Z	1.5	0.06	0	16	16	12	8	6.5	3	22	NBR=B	-10 +90
E135... ..20///...	K-N-P-W-Y-Z	2	0.09	0	12	10							
E135... ..25///...	K-N-P-W-Y-Z	2.5	0.14	0	8	5.5							
E135... ..30///...	K-N-P-Y	3	0.19	0	4.5	2							
E135... ..40///...	N-P-Y	4	0.35	0	2.5	1.2	15	11	5	4	30	EPDM=E	-10 +140
E135... ..20///...	K-N-P-W-Y-Z	2	0.09	0	25	15							
E135... ..25///...	K-N-P-W-Y-Z	2.5	0.14	0	16	8							
E135... ..30///...	K-N-P-Y	3	0.19	0	8	4							
E135... ..40///...	N-P-Y	4	0.35	0	5	2.5						FPM=V	-10 +140

② Seal
③ Coil
④ Only for connection "W"
Example: E135KB20///30B NBR seal SPIGGOT connection
Coil 24V 50/60Hz
E135W.../1/...

⑤ The maximum allowable pressure PS for steam is 2.5bar (gauge pressure)
The maximum allowable pressure is related to the type of connection and pipe used

** The temperature range is related to the material of the seals (NBR, EPDM, FPM), and the valves' body.
Please contact us concerning the temperature range referred to the different types of connection.

COILS ③	Alternating Current 50/60Hz (V)							Direct Current (V)			Electrical connection	Connectors
	12	24	48	110	220 230	240	380	12	24	48		
Series 3 Width 22	30A	30B	30C	30D	30E	30F	30G	300	301	302	DIN 46244	PG9 code 10348000
Series 4 Width 30	40A	40B	40C	40D	40E	40F	40G	400	401	402	DIN 43650A	PG9 code 10349000

DESCRIPTION
 Class F insulation
 Voltage tolerance
 AC +15% -10%
 DC ± 10%
 Protection class
 IP65 with connector fitted
 IP00 without connector
 Continuous service ED100%

OPTIONS
 Class H insulation
 Cable attached
 Special coil voltage
 Special coil powers
 CE certified coils

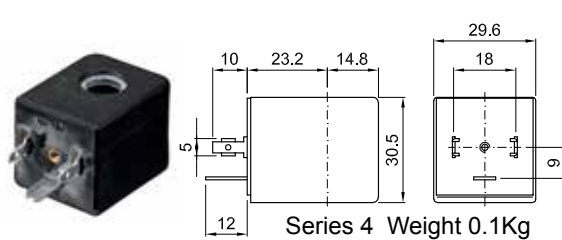
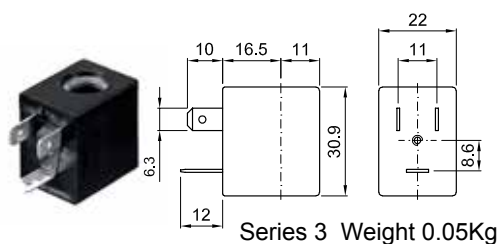

(for coil details see section 8)

SPARE PARTS LIST

1. Coil fixing nut
2. Coil
3. Plunger
4. Armature tube assembly

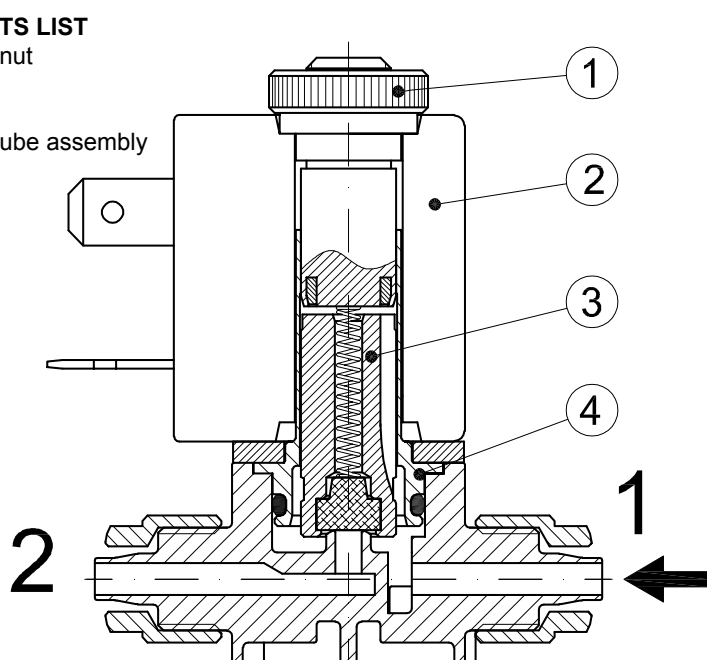

Weight with coil series 3=0.10Kg

Weight with coil series 4=0.15Kg

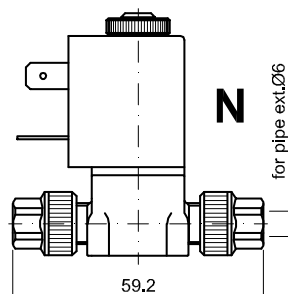
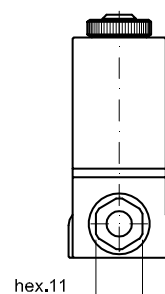
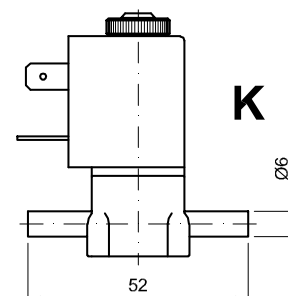
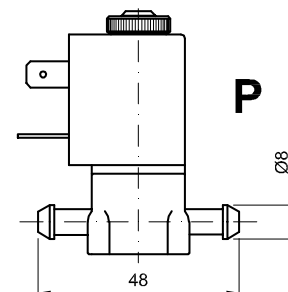
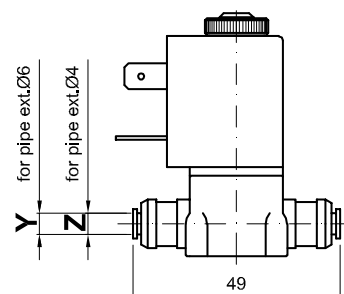
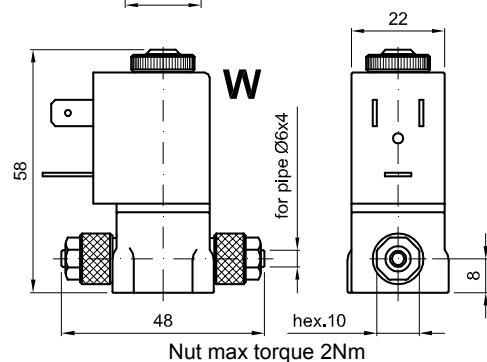
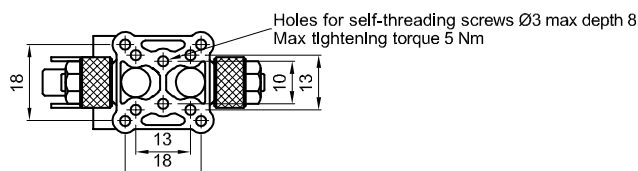

Screw the nut with wrench 11 up to the sliding on the hexagon (torque limiting device)