

Steam Trap Valve Station

BK-33/SK (FLOAT TYPE)

Scan this QR Code



DESIGN

Product Features

Body and Cover	Stainless Steel AISI 304
Internals and Float	Stainless Steel AISI 304
Thermostatic Unit	Stainless Steel AISI 304
Hand Wheel	Carbon Steel
Connections	Threaded/Socket

Operating Conditions

Max. Operating Pressure	32 bar
Max. Operating Temp.	286°C
Differential Pressure	4,5/10/14 bar

Operation

BK-33 pipe connector has been developed to be used with the steam traps in steam lines. Operates constant discharging at saturation temperature especially where the condensate amount is not fixed. Beside of the float that operates the liquid discharging, air discharging is controlled by the existing thermostatic capsule. In case, that the float loses its functionality, thermostatic capsule fulfils the task of condensate discharging.

Installation

BK-33 SK, float type steam trap can easily be installed to the pipe connector. Usually, float type steam traps are installed horizontally to the steam lines. The flow through the pipe connector should be in the arrow direction.

BK BK-33/SK



BK-43/SK

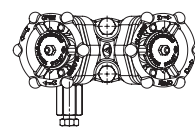

BK/53/54/SK

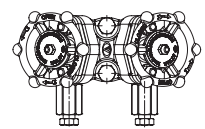

Pressure and Temperature Limitations

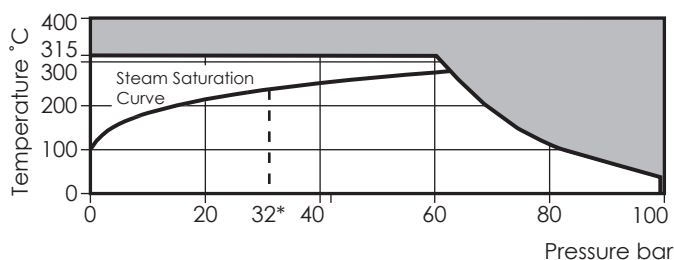

Type	Definition	Flow Direction
BK-33 SK	Pipe connector with 2 stop valves + Thermostatic steam trap + Discharging valve	Left to right
BK-43 SK	Pipe connector with 2 stop valves + Thermodynamic steam trap + Discharging valve + Test valve	Left to right
BK-53 SK	Pipe connector with 2 stop valves + Thermodynamic steam trap + Discharging valve + Test valve	Left to right
BK-54 SK	Pipe connector with 2 stop valves + Thermodynamic steam trap + Discharging valve + Test valve	Right to left

PIPELINE CONNECTORS

BK-33/SK (FLOAT TYPE)

Construction

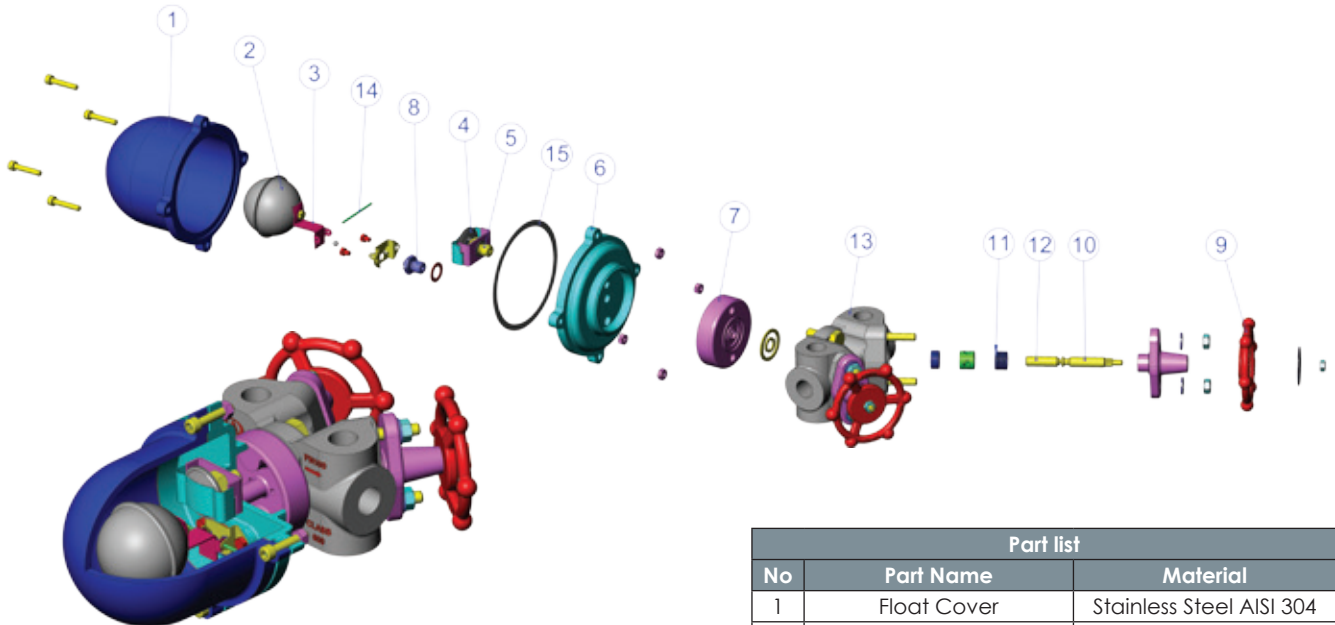

Dimensions

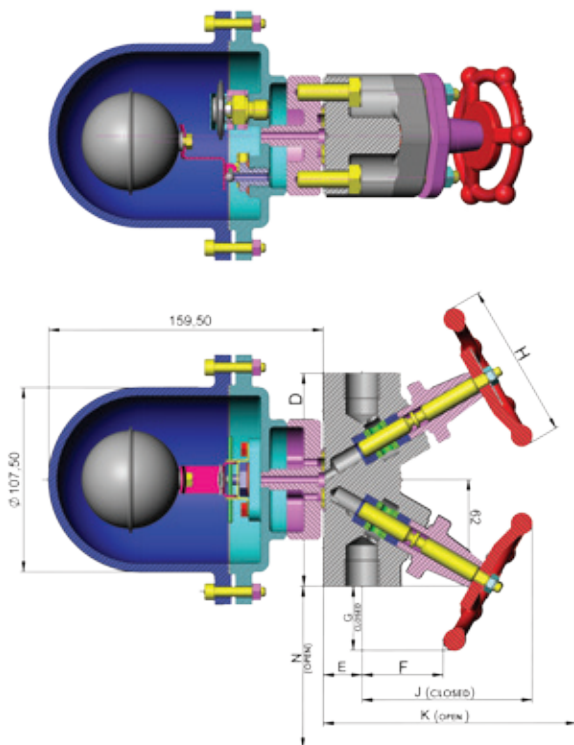

Part list		
No	Part Name	Material
1	Float Cover	Stainless Steel AISI 304
2	Float	Stainless Steel AISI 304
3	Float Lever	Stainless Steel AISI 304
4	Thermostatic Capsule	Stainless Steel AISI 304
5	Thermostatic Unit Seat	Stainless Steel AISI 304
6	Body-A	Stainless Steel AISI 304
7	Body-B	Stainless Steel AISI 304
8	Float Seat	Stainless Steel AISI 304
9	Hand Wheel	Carbon Steel C 22.8
10	Steam-A	Stainless Steel AISI 304
11	Bearing	Carbon Steel St. 37.2
12	Stem-B	Stainless Steel AISI 304
13	Body	Stainless Steel AISI 304 L
14	Float Stem	Stainless Steel AISI 304
15	Cover Gasket	Graphite

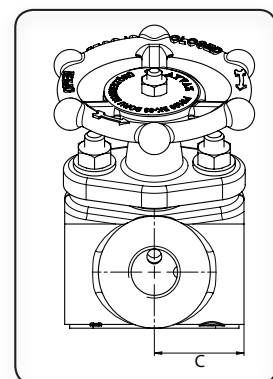

Size	BK-33 SK	BK-43 SK	BK-53 SK	BK-54 SK	THREADED									
					C (mm)	D (mm)	E (mm)	F (mm)	G (mm)	H (mm)	J (mm)	K (mm)	L (mm)	N (mm)
1/2"	703450214111	703450224111	703450234111	703450244111	36	125	25	50	35	90	99	115	22	50
3/4"	703450214112	703450224112	703450234112	703450244112	36	125	25	50	35	90	99	115	22	50

All the dimensions in the table are given in "mm".

Subject to technical alterations and deviations resulting from the manufacturing process without giving any notification.