

ELO40



SMHC1



ELO40

SELF-CHECKING HIGH WATER LEVEL CONTROLLER

GENERAL FEATURES

Regarding the operation and the controlling of the boilers, rules and regulations are subject to change due to country's applications. Nevertheless, it is clearly shown in the regulations that boilers should be operated safely without the assistance of a person when there is high-safety concern. To set high or low water level of a boiler, the design condition should be carefully inspected. Any amount above or below design limit of boiler may lead to dangerous events or inefficient working operations. These are the possible deficiencies of uncontrolled high water level:

- The transfer of water to steam may cause in malfunctioning due to dirt and / or failure of the steam system components (valve, pipe, system, process, etc.).

- Wet and dirty steam may contaminate or disrupt the produced steam. Wet steam may increase the water film thickness which may reduce the heat transfer, eventually may result in lower processing temperatures. This will cause low efficiency, increase in process duration and unit cost.

- Overfilled boiler may cause splash, damage in process and injuries of people.

With all above deficiencies, below results may occur.

Poor quality steam production, lower production rates, poor product quality. Increased maintenance cost of plant and components, damage to steam systems, possible personnel injuries

To prevent all these possible deficiencies, high level water controller should be used to control the water pump, shutting-off burner, switching off supply water valve and giving alarm to warn personnels.

Taken precautions can vary by the requirements of facilities.

ELO40 LEVEL PROBE

Protective Tube: Stainless Steel

Probe: Stainless Steel

Insulator: PTFE

Socket: Polyamide

Sealing Ring: Metal Gasket

Connection: 1/2" Threaded

Max. Working Pressure: 32 bar

Max. Working Temperature: 239 °C

SMHC1 CONTROL UNIT

Power Supply: 230 V / 50-60 Hz

Input: 4,5 VA

Fuse: 80 mA / T

Protection Class: IP40

EL040 SELF-CHECKING HIGH WATER LEVEL CONTROLLER

TECHNICAL SPECIFICATIONS

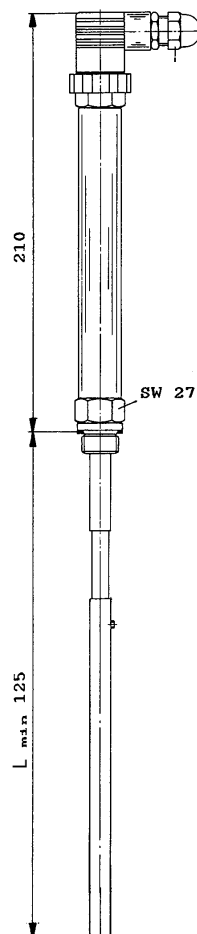
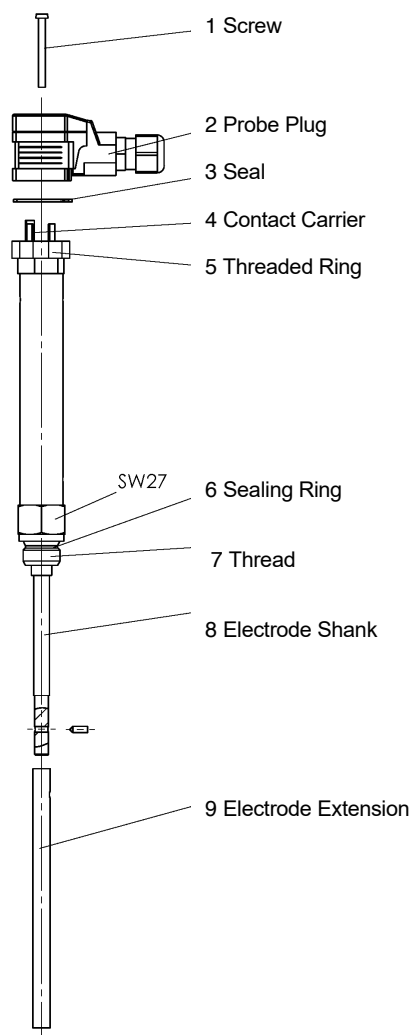
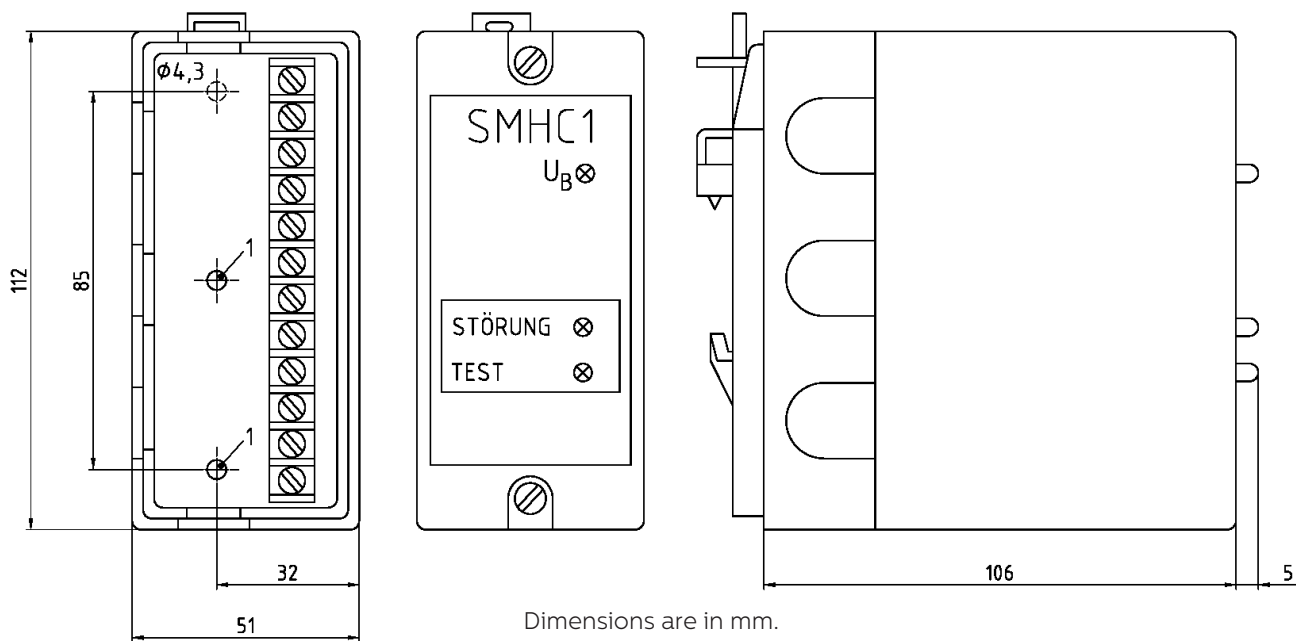

EL030
L = 500 mm
L = 1000 mm
L = 1500 mm
L = 2000 mm

L electrode length can be produce to the desires size.

EL040 SELF-CHECKING HIGH WATER LEVEL CONTROLLER

ELECTRICAL CONNECTION SCHEME

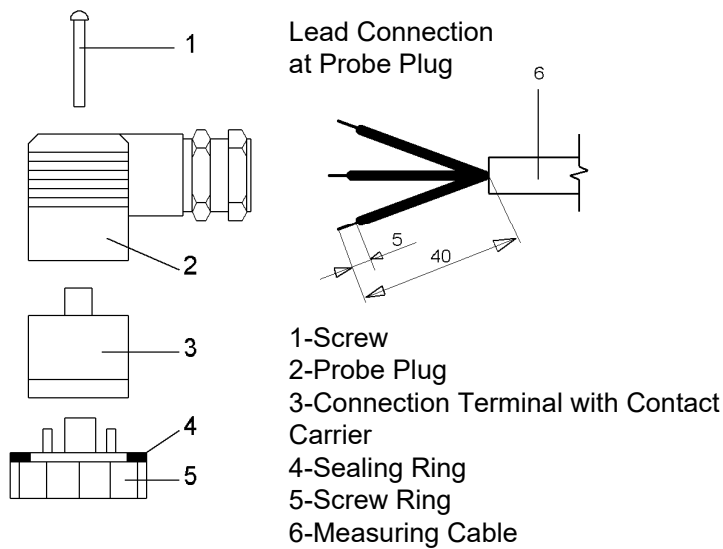
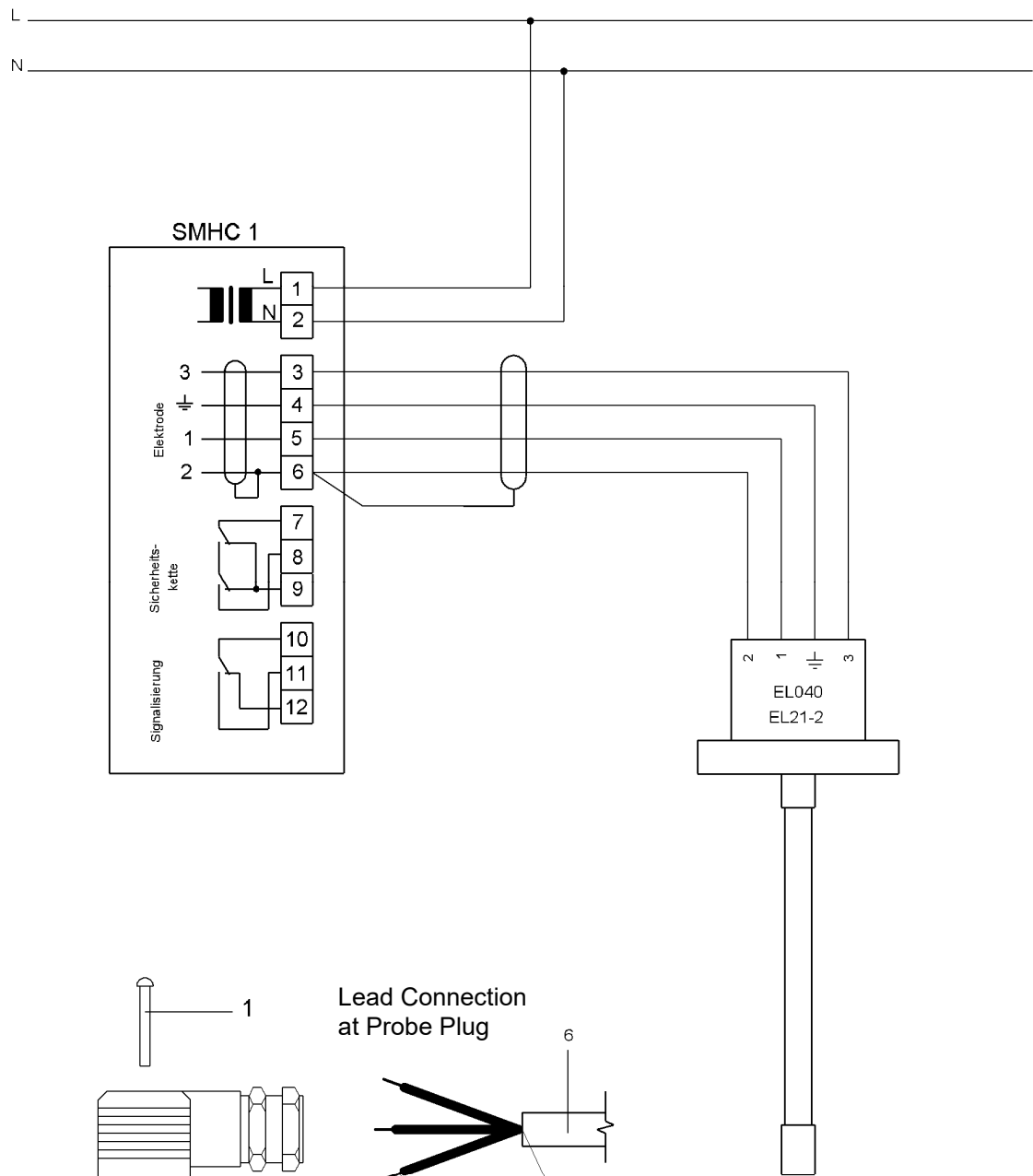

EL040 SELF-CHECKING HIGH WATER LEVEL CONTROLLER

SELF-CHECKING HIGH WATER LEVEL CONTROLLER



HEAD OFFICE - FACTORY

Atatürk Sanayi Bölgesi Hadımköy Mahallesi Mustafa İnan Caddesi No: 44 Arnavutköy - İSTANBUL
Tel: +90 212 771 01 45 (pbx) | Fax: +90 212 771 47 27
info@ayvaz.com | www.ayvaz.com

Cona Caserta/Italy

Tel: +39 0823 187 3988
rmolaro@ayvaz.com

Ayvaz Russia Moscow/Russia

Tel: +74959951728
ayvazrus@ayvaz.com

Ayvaz Germany Vierenheim/Germany

Tel: +49 62046014399
germany@ayvaz.com

Ayvaz Ukraine Kiev/Ukraine

Tel: +380 44 390 57 57
info@ayvaz.com.ua

Tricorr Warsaw/Poland

Tel: +48-32-783-295-1
tricorr@tricorr.eu

Haci Ayvaz M.E. Dubai/U.A.E

Tel: +971 563550822
+971 501306871
mideast@ayvaz.com

Ayvaz China Cixi City/China

Tel: +86 0574 5897 3851
info@ayvazchina.com

Ayvaz Kazakhstan LLP Almaty/Kazakhstan

Tel: +7 (727) 327 97 57
info_kz@ayvaz.com
www.ayvaz.kz

Ayvaz N Isperih/Bulgaria

Tel: +359 8431 27 32
office@ayvaz-n.eu

Ayvaz Serbia Belgrad/Serbia

Tel: +381 61 658 70 52
yakbiyik@ayvaz.com