

SA-50

LIQUID DRAINER

GENERAL FEATURES

Working Principle

SA-50 is used for liquid draining in gas or air lines and maintain efficiency of the system. When the system starts up, water and air enter inside of the drainer together. As the water level rises, the ball float cracks the valve to drain liquid at the same rate that it reaches the trap. Changes in the rate of flow to the trap adjust the float level and the degree of opening of the valve.

Installation

SA-50 can be installed horizontally with the pipeline. The pipeline should be constructed with a grade in order to maintain the fluid to flow into the liquid drainer constantly without any difficulty. If a large amount of condensate occurs, the air may stuck in the body of the liquid drainer. In order to prevent air stuck a balance pipe can be connected with the drainer, so condensate can flow into the drainer easily.

Connections:

Flanged and Threaded

Connection Type:

Horizontal

Dimensions:

DN25 (1") - DN50 (2")

Max. Operating Pressure:

16 bar

Max. Operating Temp:

250 °C

Applications:

- Compressors
- Heat Exchangers
- Heating Batteries
- Air Tanks
- Air Separators
- Air Pockets
- Air Collectors
- Drying Cylinders



SA-50 LIQUID DRAINER

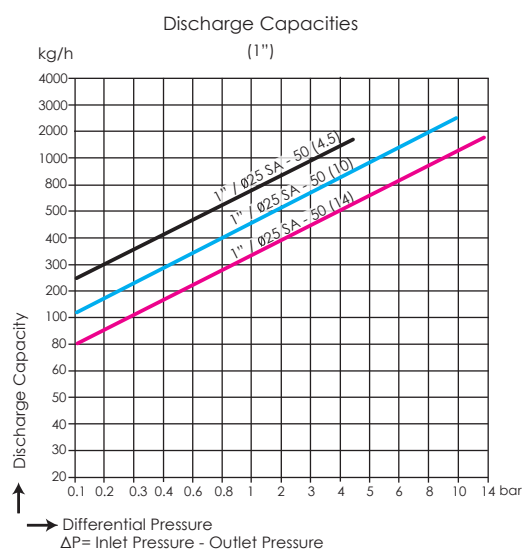
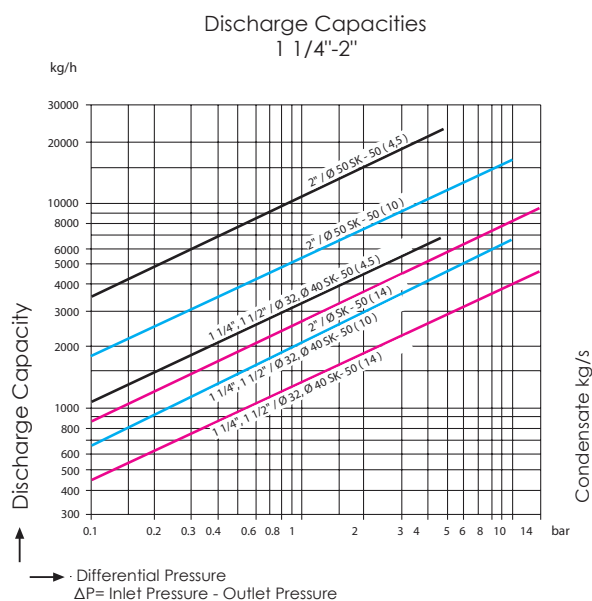

1" CONSTRUCTION

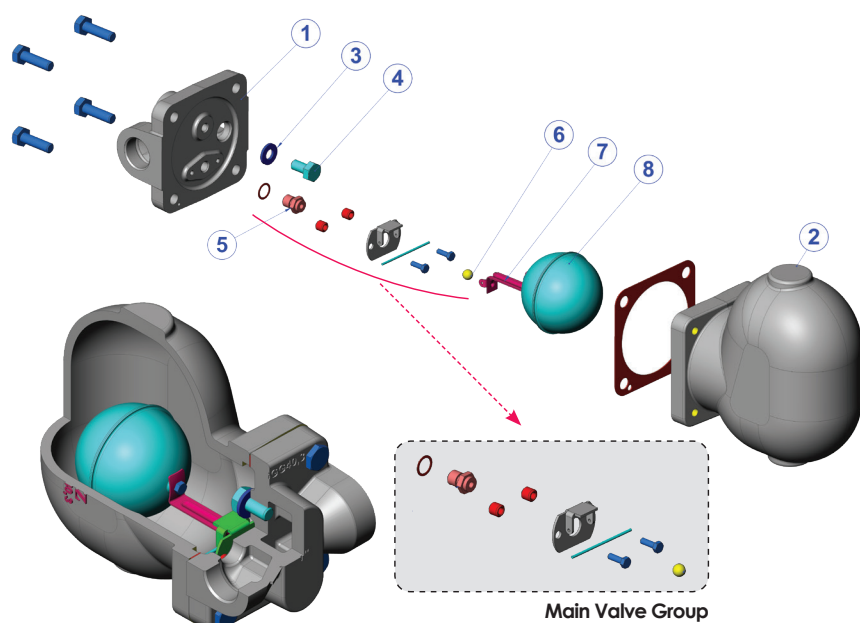

1" PART LIST		
NO	PART NAME	MATERIAL
1	Cover	Ductile Iron GGG 40.3
2	Body	Ductile Iron GGG 40.3
3	Gasket	Graphite
4	Bolt	Stainless Steel
5	Balancing Plug	Carbon Steel St. 37.2
6	On-Off Ball	Carbon Steel St. 37.2
7	Float Lever	Stainless Steel AISI 304
8	Float	Stainless Steel AISI 440C

SA-50 LIQUID DRAINER

1" DIMENSIONS

SA-50 1" Threaded

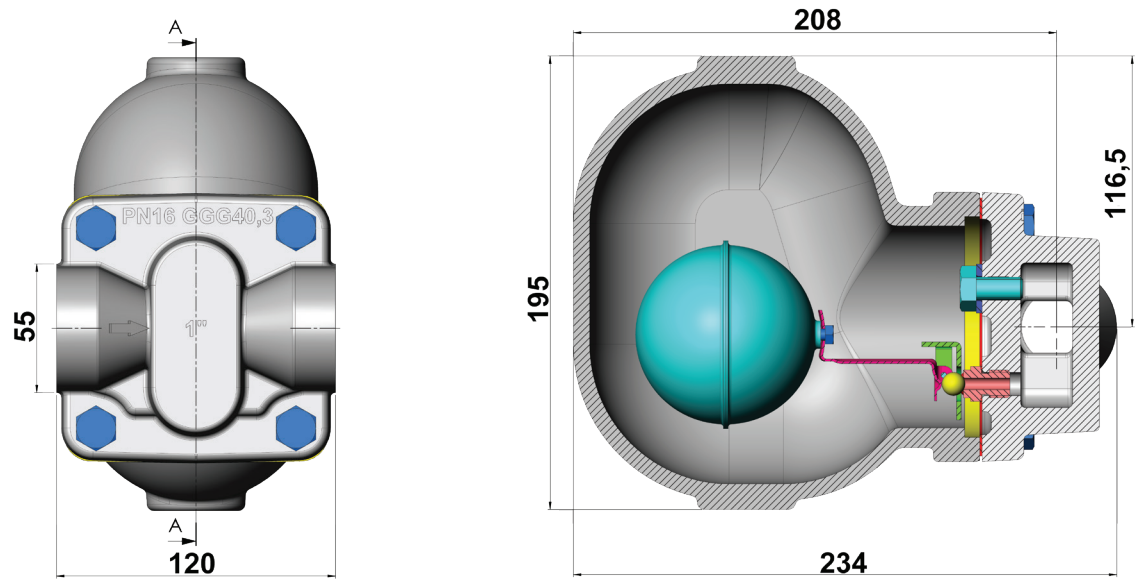

SA-50 DN25 Flanged

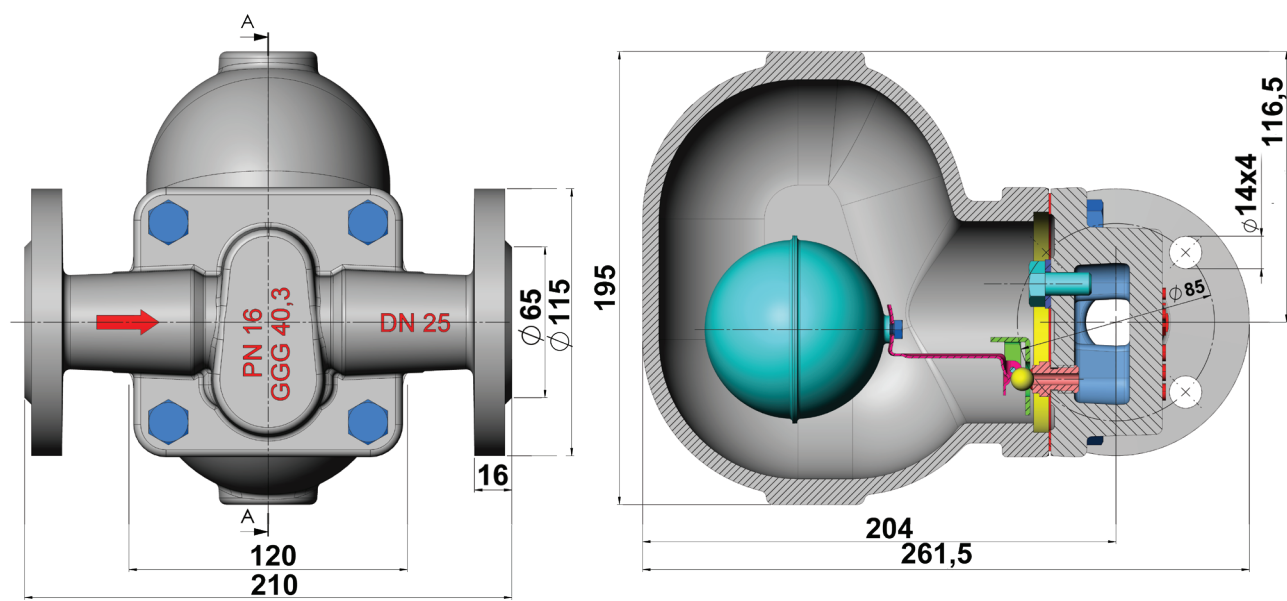

All the dimensions in the table are given in "mm".
Subject to technical alterations and deviations resulting from the manufacturing process without giving any notification.

SA-50 LIQUID DRAINER

1 1/4" - 2" CONSTRUCTION

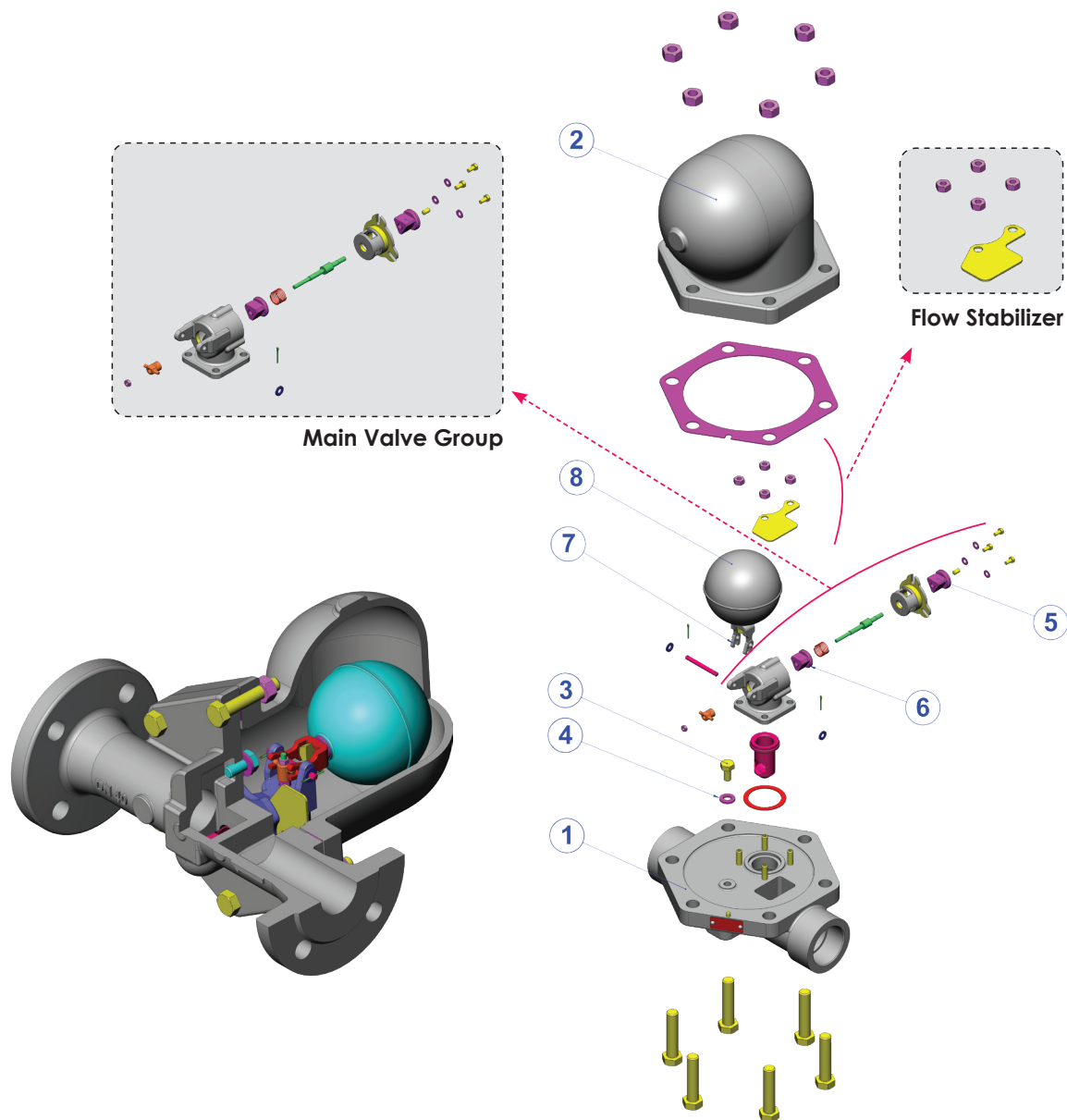

1 1/4" - 2" PART LIST		
NO	PART NAME	MATERIAL
1	Cover	Ductile Iron GGG 40.3
2	Body	Ductile Iron GGG 40.3
3	Bolt	Stainless Steel
4	Gasket	Stainless Steel
5	Float Seat	Stainless Steel AISI 304
6	Main Valve (Ball)	Stainless Steel
7	Float Lever	Stainless Steel AISI 304
8	Float	Stainless Steel AISI 440C

All the dimensions in the table are given in “mm“.
Subject to technical alterations and deviations resulting from the manufacturing process without giving any notification.

SA-50 LIQUID DRAINER

1 1/4" - 2" DIMENSIONS

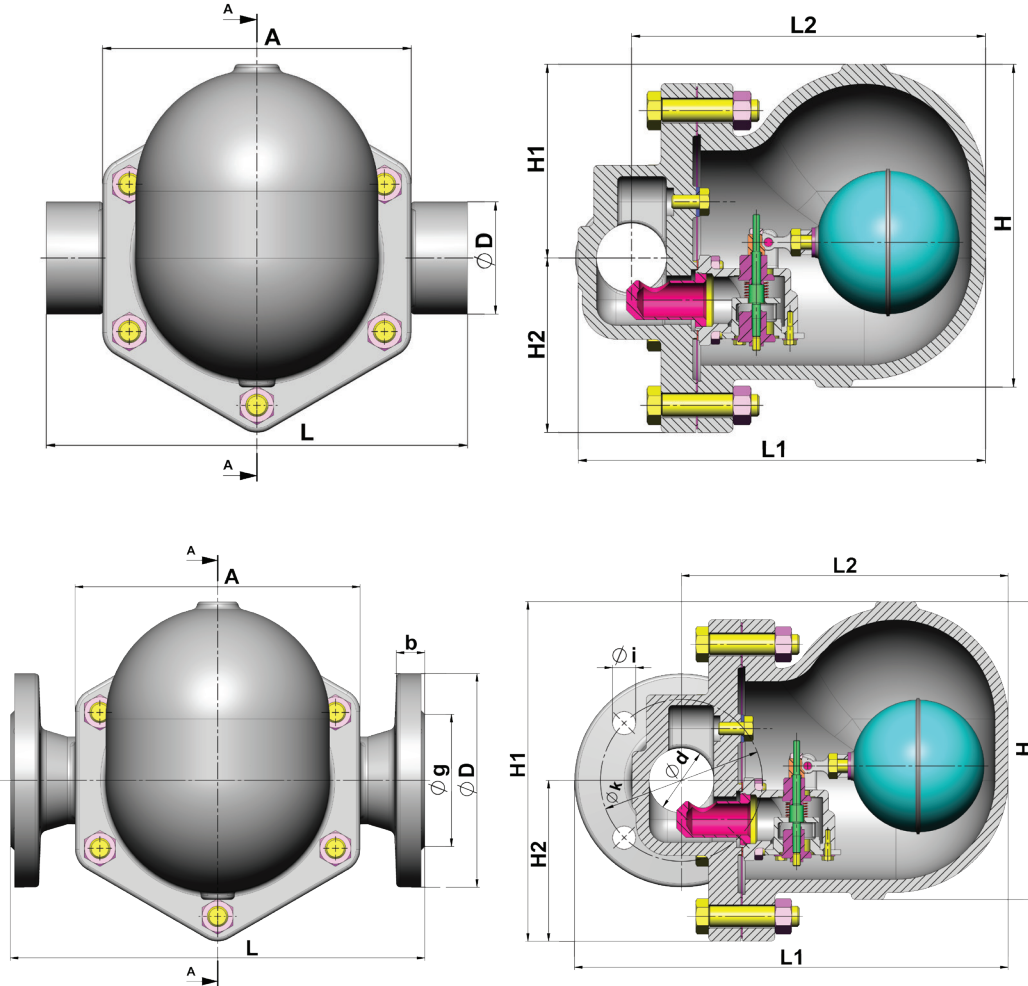

DIMENSIONS												
Size	FLANGED											
	ØD (mm)	Øk (mm)	Øg (mm)	b (mm)	Øixn (mm)	A (mm)	H1 (mm)	H2 (mm)	H (mm)	L1 (mm)	L2 (mm)	L (mm)
DN 32	140	100	78	20	18x4	190	237.5	107.5	207	277	245	320
DN 40	150	110	88	20	18x4	190	237.5	107.5	207	277	245	320
DN 50	160	125	102	22	18x4	220	262	124	230	290	252	320

Size	THREADED							
	ØD (mm)	A (mm)	H1 (mm)	H2 (mm)	H (mm)	L1 (mm)	L2 (mm)	L (mm)
11/4"	70	190	207	237.5	207	107.5	277	270
11/2"	70	190	207	237.5	207	107.5	277	270
2"	80	220	230	230	220	124	290	300