



# Dyna-Mation DM1

**Your configured part number: DM-600x0.125-FB**

## Features and Benefits

- **Built to Last:**
  - NFPA interchangeability
  - Heads machined from solid aluminum, black anodized
  - Hard anodized aluminum tubes
- **High Quality Components:**
  - Long wearing oil impregnated bronze rod bearing
  - Wear-compensating Buna N dynamic seals
- **Numerous Options and Configurations:**
  - Available cushions absorb shock
  - Double-rod option provides dual power and prevents rod deflection
- **Time-Tested Design:**
  - Solid high-alloy aluminum pistons with PTFE wear bands
  - Rods are hard chrome plated ground and polished steel

## Engineering Specifications

**Pressure Rating:** 250 PSI Air / Contact Mead for hydraulic pressure rating

**Temperature Range:** -40° F (-40° C) to 250° F (121° C) standard, up to 400° F (204° C) available

**Filtration:** Not essential but a 40µ filter will prolong seal life

**Lubrication:** Not necessary but will prolong seal life when operated with dry air

### **Materials:**

Heads: Aluminum, black anodized

Tubes: Aluminum hard anodized to 60 Rc (16 RMS finish)

Bearing: Long wearing oil impregnated porous bronze

Piston and Rod Seals: Wear compensating Buna-N vee rings

## Service and Design Capabilities

- **Contact Mead for any special valve need**
- **Experienced application engineers are available to provide complete pneumatic circuit solutions**
- **A full line of products including air preparation, valves, actuators, and specialty components are available**
- **Fast shipping and helpful customer service**
- **Custom design capabilities to meet your needs**
- **Call (877) MEAD-USA (877-632-3872)**

Bimba Manufacturing Company  
Monee, IL 60449-0068  
Telephone: 708.534.8544  
Toll Free: 800-44-BIMBA  
Email: [cs@bimba.com](mailto:cs@bimba.com)  
[www.bimba.com](http://www.bimba.com)

**Leaders in Actuation.**

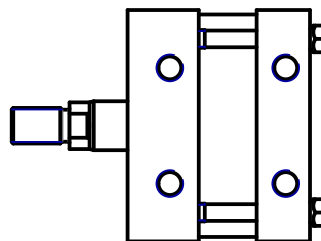
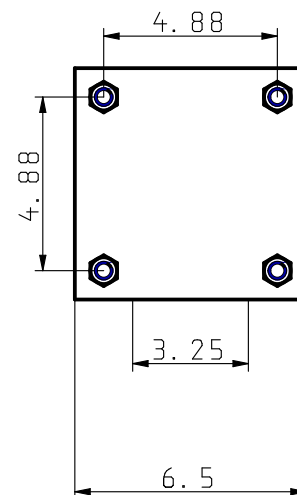
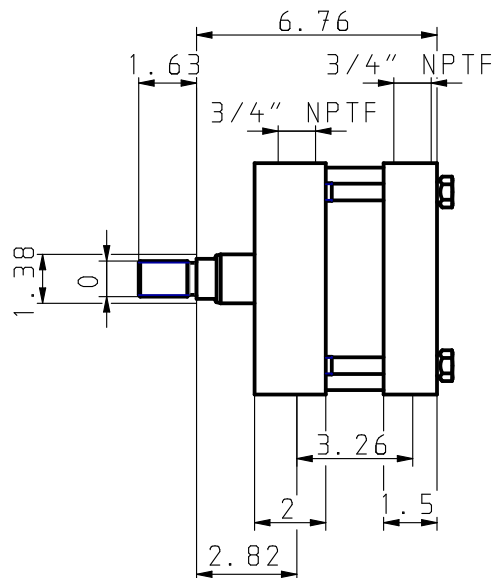
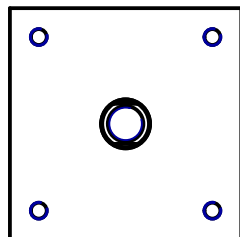

DM-600x0.125-FB

THIS DRAWING CONTAINS PROPRIETARY DESIGNS AND/OR INFORMATION OF BIMBA MFG. CO. OR ITS SUBSIDIARIES AND IS NOT TO BE TRANSMITTED, REPRODUCED, USED OR DISCLOSED WITHOUT WRITTEN PERMISSION OF BIMBA MFG. CO. OR ITS SUBSIDIARIES. DESIGN REFLECTS OUR BEST ENGINEERING OPINION BASED ON WRITTEN APPLICATION SPECIFICATIONS RECEIVED. SUITABILITY OF A DESIGN FOR AN APPLICATION REQUIRES ANALYSIS AND/OR TESTS IN YOUR SPECIFIC SYSTEM.

Bimba is part of  
**IMI** Precision  
Engineering



**Bimba Manufacturing Co.**

Monee, IL. 60449  
(800) 442-4622 [www.bimba.com](http://www.bimba.com)

PROPRIETARY DRAWING - Reference Only