



Your configured part number: HD1-400x0.125-FB

Features and Benefits

- **Cylinders for Abusive Conditions:**
 - NFPA interchangeability and high quality components
 - Offer long service life in harsh conditions
 - Non-lube seals available
- **External Bearing Ensures Smooth Motion:**
 - Teflon impregnated and hardcoat anodized, external rod bearing
 - Improves rod motion while maintaining rigidity and stability
- **Built to Last:**
 - Heads machined from solid aluminum, black anodized
 - Hard anodized aluminum tubes
- **Easy to Repair:**
 - Rod gland and bearing may be replaced without disassembling cylinder
 - Tie-rod design limits down time

Engineering Specifications

Pressure Rating: 250 PSI Air / Contact Mead for hydraulic pressure rating

Temperature Range:

-40° F (-40° C) to 250° F (121° C) standard,
up to 400° F (200° C) available

Filtration: Not essential but a 40µ filter will prolong seal life

Lubrication: Not necessary but will prolong seal life when operated with dry air

Materials:

Heads: Aluminum, black anodized

Rod: Hard chrome plated ground and polished steel

Rod Bearing: Teflon[®]-impregnated, hard coated aluminum

Rod Wiper: Dupont Teflon[®]

Piston: High alloy aluminum with PTFE wear band

Service and Design Capabilities

- **Experienced application engineers are available to provide complete pneumatic circuit solutions**
- **A full line of products including air preparation, valves, actuators, and specialty components are available**
- **Fast shipping and helpful customer service**
- **Custom design capabilities to meet your needs**
- **Call (877) MEAD-USA (877-632-3872)**

Leaders in Actuation.

Bimba Manufacturing Company
Monee, IL 60449-0068
Telephone: 708.534.8544
Toll Free: 800-44-BIMBA
Email: cs@bimba.com
www.bimba.com

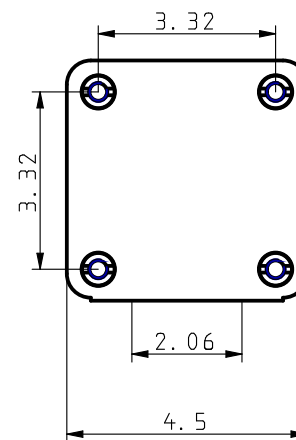
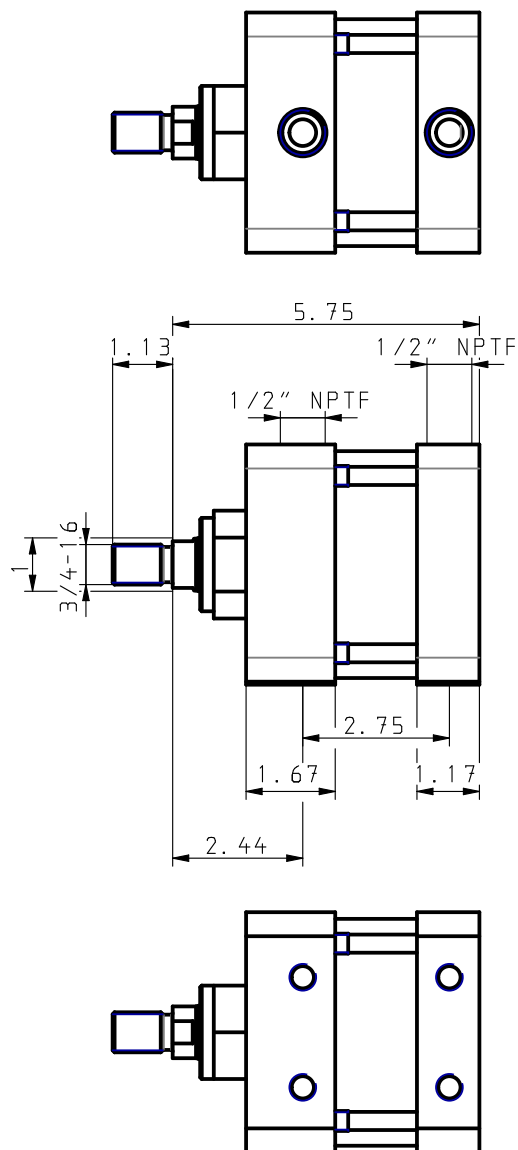
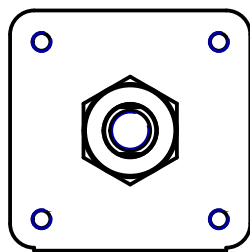

HD1-400x0.125-FB

THIS DRAWING CONTAINS PROPRIETARY DESIGNS AND/OR INFORMATION OF BIMBA MFG. CO. OR ITS SUBSIDIARIES AND IS NOT TO BE TRANSMITTED, REPRODUCED, USED OR DISCLOSED WITHOUT WRITTEN PERMISSION OF BIMBA MFG. CO. OR ITS SUBSIDIARIES. DESIGN REFLECTS OUR BEST ENGINEERING OPINION BASED ON WRITTEN APPLICATION SPECIFICATIONS RECEIVED. SUITABILITY OF A DESIGN FOR AN APPLICATION REQUIRES ANALYSIS AND/OR TESTS IN YOUR SPECIFIC SYSTEM.

Bimba is part of
IMI Precision
Engineering



Bimba Manufacturing Co.

Monee, IL. 60449
(800) 442-4622 www.bimba.com

PROPRIETARY DRAWING - Reference Only