



IntelliSense[®] Pressure/Temperature Sensor

Your configured part number: **ISS-1A-7SS**

Features and Benefits

Combination pressure and temperature sensor:

- Proprietary communication protocol for use with an IntelliSense[®] Sensor Interface Module
- 10-32 thread SS pressure port
- IP69K rated when used with appropriate cables
- Male four pin micro M8 connector

Engineering Specifications

Pressure Sensing Performance Specification:

Rated pressure: 0 psia [0 bar(a)] to 200 psia [14 bar(a)]

Overpressure rating: 2X Rated Pressure

Burst pressure: 5X Rated Pressure

Resolution: 0.01 psi [0.001 bar]

Accuracy: 0 psi [0 bar] to 87 psi [6 bar]

32° F [0° C] to 104° F [40° C] ±0.29psi [± 20 mbar]

-40° F [-40° C] to 185° F [85° C] ±0.58psi [± 40 mbar]

Response time: 1 ms

Temperature Sensing Performance Specification:

Temperature Range: -9° F [-15° C] to 127° F [60° C]

Resolution: <0.02° F [0.01° C]

Accuracy: ±18° F [±10° C]

Service and Design Capabilities

- Replacement part
- Requires IntelliSense[®] Sensor Interface Module (SIM) to collect data
- Order IntelliSense[®] Kit if both SIM and Sensors are needed

Bimba Manufacturing Company
Monee, IL 60449-0068
Telephone: 708.534.8544
Toll Free: 800-44-BIMBA
Email: cs@bimba.com
www.bimba.com

Leaders in Actuation.

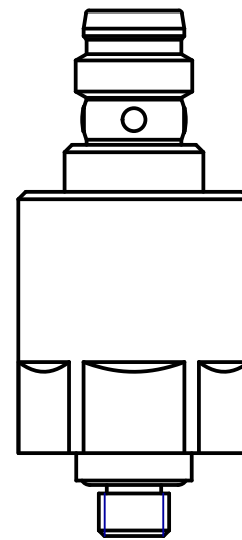
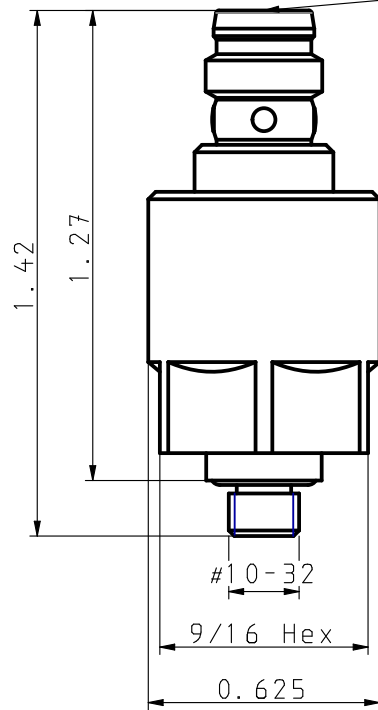
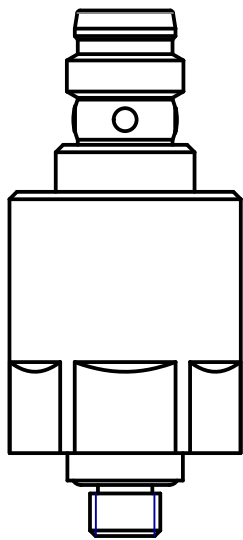
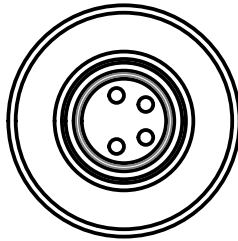

ISS-1A-7SS

THIS DRAWING CONTAINS PROPRIETARY DESIGNS AND/OR INFORMATION OF BIMBA MFG. CO. OR ITS SUBSIDIARIES AND IS NOT TO BE TRANSMITTED, REPRODUCED, USED OR DISCLOSED WITHOUT WRITTEN PERMISSION OF BIMBA MFG. CO. OR ITS SUBSIDIARIES. DESIGN REFLECTS OUR BEST ENGINEERING OPINION BASED ON WRITTEN APPLICATION SPECIFICATIONS RECEIVED. SUITABILITY OF A DESIGN FOR AN APPLICATION REQUIRES ANALYSIS AND/OR TESTS IN YOUR SPECIFIC SYSTEM.

Bimba is part of
IMI Precision
Engineering



Bimba Manufacturing Co.

Monee, IL. 60449
(800) 442-4622 www.bimba.com

PROPRIETARY DRAWING - Reference Only