



Original Line® Non-Rotating

Your configured part number: NR-500.011-D
Additional accessories: (NO ACCESSORIES)

Features and Benefits

- **Maintenance Free Performance:**
 - Lubed for life w/proprietary synthetic blend grease
 - Blue and Improved design doubles previous cylinder life
- **Unique Square Rod with Rounded Corners:**
 - Provides superior rotational control
 - Rounded corners provide longer seal life than conventional hexagon rods
 - All bore sizes have rotational control of less than or equal to ± 3 degrees
- **Low Breakaway:**
 - Inflatable, wear compensating, U-cup rod and piston seals
 - Breakaway slots on each end cap for fast seal inflation

Engineering Specifications

Pressure Rating: 250 PSI

Temperature Range:

Buna N seals: -20° F (29° C) to 200° F (90° C)

Fluoroelastomer seals for high temperatures (up to 400° F) available

Magnetic piston option: max. operating temp. is 185° F

Materials:

Rod: Stainless steel piston rod standard

Body: 304 stainless steel

End Caps: 6061 aluminum (RoHS compliant)

Service and Design Capabilities

- **Catalog models available in 4 days or less**
- **Custom design capabilities for your needs**
- **Common modifications include:**
 - Custom rod threads/lengths
 - Customer logo/part# on cylinder body
 - Additional standard port sizes/locations
 - Special lubricants (FDA approved, etc.)
 - Anodized or nickel plated end caps
 - Clean room design with Krytox lubrication
 - Special spring forces

Leaders in Actuation.

Bimba Manufacturing Company
Monee, IL 60449-0068
Telephone: 708.534.8544
Toll Free: 800-44-BIMBA
Email: cs@bimba.com
www.bimba.com

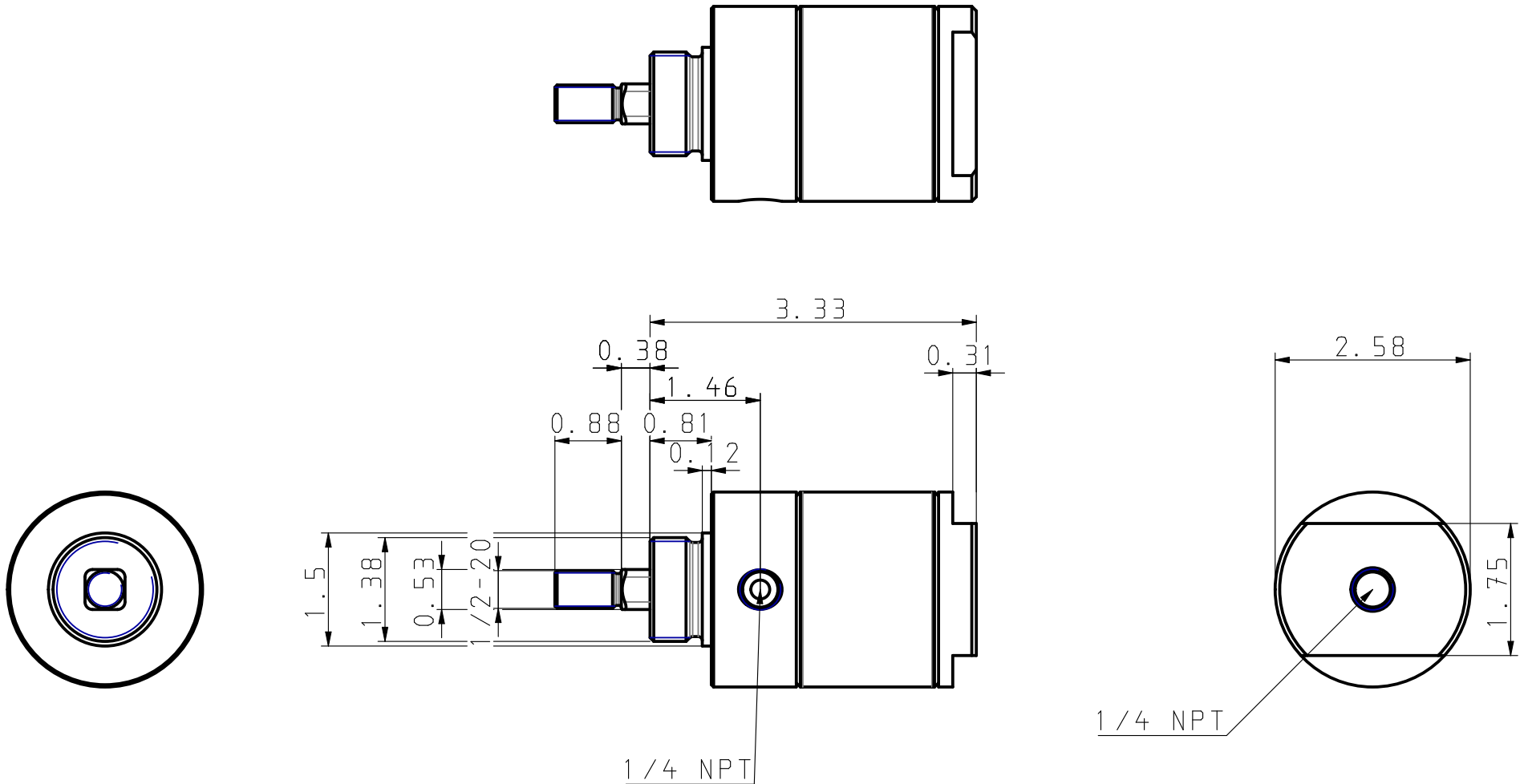

NR-500.011-D
(NO ACCESSORIES)

THIS DRAWING CONTAINS PROPRIETARY DESIGNS AND/OR INFORMATION OF BIMBA MFG. CO. OR ITS SUBSIDIARIES AND IS NOT TO BE TRANSMITTED, REPRODUCED, USED OR DISCLOSED WITHOUT WRITTEN PERMISSION OF BIMBA MFG. CO. OR ITS SUBSIDIARIES. DESIGN REFLECTS OUR BEST ENGINEERING OPINION BASED ON WRITTEN APPLICATION SPECIFICATIONS RECEIVED. SUITABILITY OF A DESIGN FOR AN APPLICATION REQUIRES ANALYSIS AND/OR TESTS IN YOUR SPECIFIC SYSTEM.

Bimba is part of
IMI Precision
Engineering



Bimba Manufacturing Co.

Monee, IL. 60449
(800) 442-4622 www.bimba.com

PROPRIETARY DRAWING - Reference Only