

# Stainless Steel Immersion Pumps

## TVG900...1000

Closed impellers

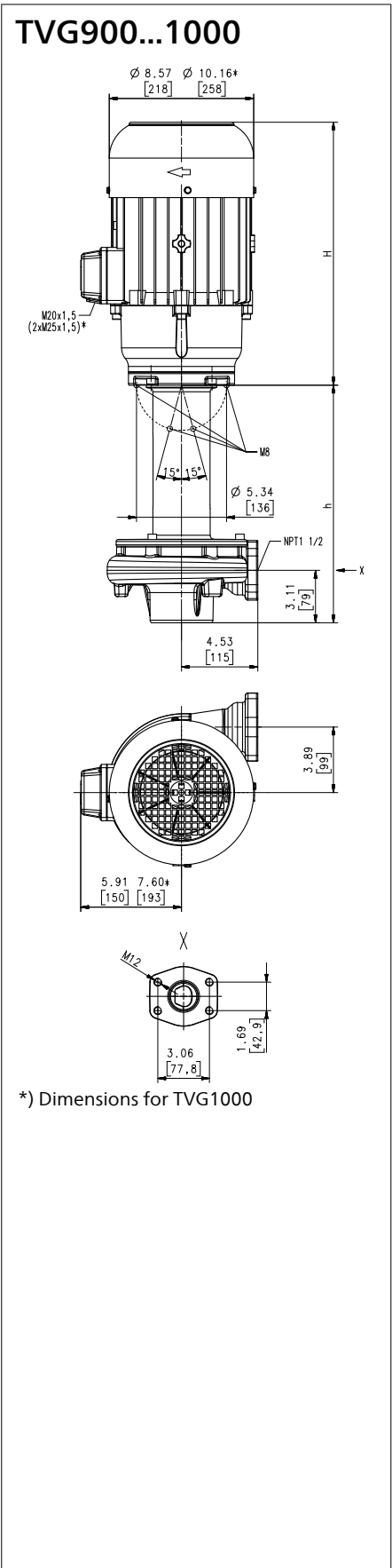

Type	Flow at head	Height	Depth of im-mersion		Weight		Power	Voltage	Fre- quen- cy	Current Speed	
	GPM /Feet l/min /m	H inch mm	h inch	h mm	Lbs	kg	HP kW	V	Hz	AMPS	RPM
TVG900S360	125/118	16.8	14.09	358	152.1	69	7.7	230	60	19.0	3520
	500/35	426					5.75	460	60	9.5	3520
	580		22.76	578	165	75					
	880		30.63	778	194	88					
1100			43.23	1098	207	94					
TVG1000S360	150/138	18.4	14.09	358	201	91	10	230	60	23.0	3545
	600/40	468					7.48	460	60	11.5	3545
	580		22.76	578	214	97					
	880		34.57	878	240	109					
1100			43.23	1098	254	115					



**Stainless Steel Immersion Pumps**

are centrifugal pumps of compact design with the impeller mounted directly onto the extended motor shaft.  
The **TVG pump** series maximizes hydraulic efficiencies with its **closed impeller** design. These pump series are both particularly well suited for industrial washing applications of metal parts.  
Complete pump and plate assemblies, including discharge pipe and mounting plate are available upon request.

**Applications**

- Types of fluid
- Industry water
  - coolants
  - cooling/cutting oils
  - lees / solvents
  - de-ionized water
- Kinematic viscosity
- ...90 SSU (...20 mm<sup>2</sup>/s)
- Pumping temperature
- 30...194 °F (0...90 °C)

**Construction**

Pump body	CrNi-steel
Cover	CrNi-steel
Impeller	CrNi-steel
Shaft	CrNi-steel
Optional:	
Suction cover	with threaded inlet
Noise level	
TVG900	74 dBA
TVG1000	77 dBA

