

▼ Shown from left to right: G4089L, G2535L, G4040L



Glycerine-Filled (G-Series)

- Dual scale reading calibrated in psi and bar
- All pressure sensing parts sealed and dampened by glycerine for long life
- Includes safety blow-out disk and pressure equalizing membrane
- Gauge snubbers or needle valves recommended for high-cycle applications.

High-Cycle Dry Gauges (H-Series)

- Dual scale reading calibrated in psi and bar
- Ideal for use in many applications, specifically for high-cycle and harsh environments
- Gauge snubbers or needle valves recommended to shut-off gauge when not in use.

Visual Reference of System Pressure



Gauge Adaptor Assembly

45° Angled gauge adaptor **GA45GC** for easier gauge reading.

Page: 150



Gauge Adaptor

For easy gauge installation into almost any system, Enerpac offers a complete line of gauge adaptors.

Page: 151



Snubber Valve V91

Infinitely adjustable for metering oil out of a gauge. The V91 Snubber Valve is also suitable as a shut-off valve to protect the gauge during high cycle applications.

Page: 152



◀ When lifting or pressing, always use a gauge. A gauge is your 'window' to the system. It lets you see what's going on.

Hydraulic Pressure Gauges



CAUTION! When lifting or pressing, always use a gauge

Do not override factory setting of relief valves. Always use a gauge to check system pressure. A gauge is your 'window' to the system. It lets you see what's going on. See our Safety Instructions.

Page: 400

**G
H
Series**



Pressure Range:

0 - 15,000 psi

Face Diameter:

2.5 - 4.0 inches

Accuracy, % of full scale:

± 1.0 - 1.5%

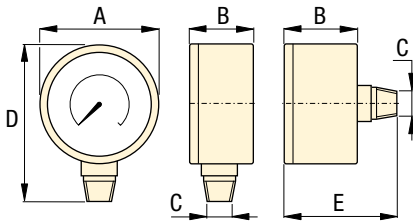

Size (in)	Connection	Dimensions (in)				
		A	B	C	D	E
2.5	Lower Mount	2.50	1.46	1/4" NPTF	3.31	—
2.7	Center Rear	2.72	1.26	1/4" NPTF	—	2.15
4.0	Lower Mount	4.00	1.15	1/4" NPTF	4.80	—
4.0	Lower Mount	4.00	1.93	1/2" NPTF	5.38	—

Note: dimensions for reference only.



Maximum Indicator Pointer

Indicator retains peak reading of pressure or force generated by the system.

Can easily be installed on GP and H-Series
ø 4 inch gauges. Order model number: **H4000G**.

▼ SELECTION CHART

Gauge Series	Pressure Range		Model Number				Major Graduation		Minor Graduation		Major Graduation		Minor Graduation	
			ø 2.5" ¼" NPTF Lower Mount	ø 2.5" ¼" NPTF Center Rear	ø 4.0" ¼" NPTF Lower Mount	ø 4.0" ½" NPTF Lower Mount								
			Accuracy: ± 1.5 %		Accuracy: ± 1.0 %		psi				bar			
	psi	bar					ø 2.5"	ø 4.0"	ø 2.5"	ø 4.0"	ø 2.5"	ø 4.0"	ø 2.5"	ø 4.0"
G-Series	0-100	0-7	G2509L	—	—	—	10	—	2	—	1	—	0.01	—
	0-160	0-11	G2510L	—	—	—	10	—	2	—	1	—	0.02	—
	0-200	0-14	G2511L	—	—	—	50	—	5	—	1	—	0.02	—
	0-300	0-20	G2512L	—	—	—	50	—	5	—	5	—	0.50	—
	0-600	0-40	G2513L	—	—	—	100	—	10	—	10	—	1	—
	0-1,000	0-70	G2514L	G2531R	—	—	100	—	20	—	10	—	1	—
	0-2,000	0-140	G2515L	—	—	—	500	—	50	—	10	—	2	—
	0-3,000	0-200	G2516L	—	—	—	500	—	50	—	50	—	5	—
	0-6,000	0-400	G2517L	G2534R	—	—	1000	—	100	—	100	—	10	—
	0-10,000	0-700	G2535L	G2537R	G4088L	G4039L	2000	1000	200	100	100	100	10	10
	0-15,000	0-1000	G2536L	G2538R	G4089L	G4040L	3000	3000	200	200	100	100	20	20
H-Series	0-10,000	0-700	—	—	H4049L	H4071L	—	1000	—	100	—	100	—	10