

▼ Shown from left to right: P77, P80, P84, P801, P39



- Reduced handle effort and ergonomic grip for less operator fatigue
- Two-speed operation for fast and easy operation (except P39)
- Vent free reservoir eliminates spills
- Quick grip handle allows for easy transport
- Integral reservoir over-pressurization protection
- All steel construction, chrome plated plunger and wiper system for durable, long lasting performance
- 4-way valving on P84 and P464 for operation of double-acting cylinders.

▼ In the absence of a power supply, the P80 Hand Pump offers a powerful solution. Alternatively, a battery-powered cordless pump can be used.



The Solution for Tough Jobs



Two-Speed Pumps

Recommended for applications where cylinder plunger must advance rapidly to load contact, and applications where greater oil capacities are required, such as multiple cylinder hook-ups.



Foot Pump Conversion Kits

Convert your P39, P77, P80 or P801 to foot power with the **PC11** Kit. Includes instructions for easy conversion.



GA45GC Gauge Adaptor

Protect yourself from system overloading by simply ordering one part number for a pre-assembled gauge, adaptor block and coupler.

Page: **150**



4-Way Control Valve

P84 and **P464** feature a manual 4-way control valve, designed for use with one double-acting or two single-acting cylinders. For system

set-up information:

Page: **404**

Pump Type	Usable Oil Capacity (in ³)	Model Number	Pressure Rating ²⁾ (psi)		Oil Displacement per Stroke (in ³)		Max. Handle Effort (lbs)
			1 st stage	2 nd stage	1 st stage	2 nd stage	
Single	41	P39	-	10,000	-	0.15	85
	41	P77	500	10,000	1.00	0.15	88
	134	P80 ¹⁾	500	10,000	1.00	0.15	77
Two-Speed	250	P801	500	10,000	1.00	0.15	77
	134	P84 ³⁾	500	10,000	1.00	0.15	77
	453	P462	200	10,000	7.69	0.29	110
	453	P464 ³⁾	200	10,000	7.69	0.29	110

¹⁾ Available as a set, see note on next page.

²⁾ Contact Enerpac for applications where operating pressure is less than 10% of pressure rating.

³⁾ P84 and P464 are for use with double-acting cylinders.



Speed Chart

To determine how a specific pump will operate your cylinder, see the Pump-Cylinder Speed Chart in the 'Yellow Pages'.

Page: 409

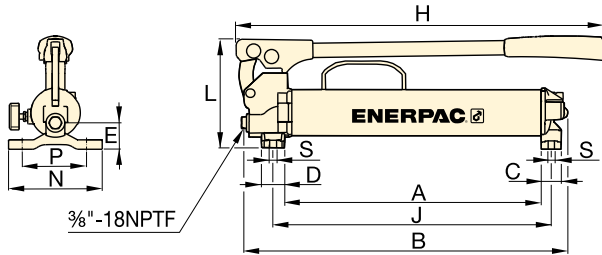

P39, P77

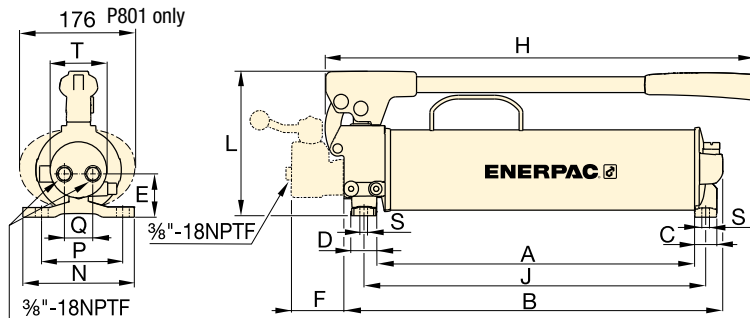

P80, P801, P84

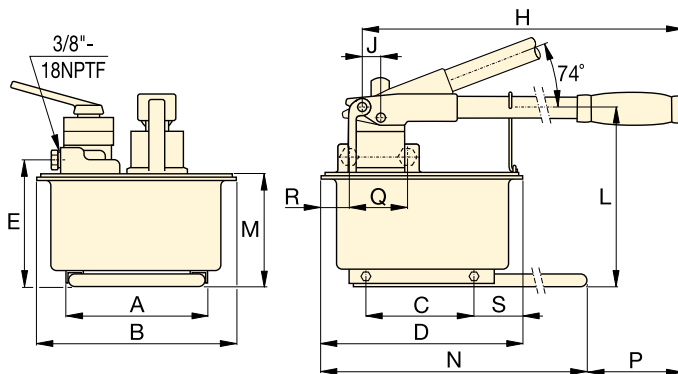

P462, P464

P Series



Reservoir Capacity:
41 - 453 in³

Flow at Rated Pressure:
0.15 - 0.29 in³/stroke

Maximum Operating Pressure:
10,000 psi



Extra Capacity Hand Pumps

P462 and **P464** feature extra large reservoirs and high first-stage flow rate. These pumps are ideally suited for powering high-capacity cylinders.

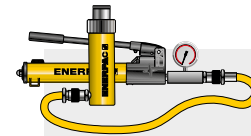

Pump-Cylinder Sets

The **P80** is also available as **complete set** (pump, cylinder, gauge, couplers and hose) for your ordering convenience.

Page: 6



Cylinder Matching Chart

For help in selecting the correct hand pump for your application, please refer to the Cylinder Matching Chart located in the 'Yellow Pages'.

Page: 402

	Piston Stroke	Dimensions (in)																	Model Number
		(in)	A	B	C	D	E	F	H	J	L	M	N	P	Q	R	S		
	1.00	15.09	18.91	1.18	1.38	1.48	–	21.63	16.37	6.39	–	5.51	4.37	–	–	0.33	–	13.6	P39
	1.00	15.39	19.19	1.18	1.38	1.86	–	21.63	16.67	6.39	–	5.51	4.37	–	–	0.33	–	15.6	P77
	1.00	16.83	20.12	1.18	1.38	2.17	–	23.50	18.11	7.65	–	5.91	4.76	1.65	–	0.33	2.93	23.6	P80 ¹⁾
	1.00	16.83	20.12	1.18	1.38	2.17	–	23.50	18.11	7.65	–	5.91	4.76	1.65	–	0.33	2.93	31.0	P801
	1.00	16.83	20.06	1.18	1.38	2.30	2.77	22.78	18.11	7.65	–	5.91	4.76	1.50	–	0.33	2.93	26.0	P84 ³⁾
	1.50	8.25	12.13	6.42	12.63	7.68	–	26.44	.98	10.63	6.89	25.6	3.63	–	–	3.13	–	61.0	P462
	1.50	8.35	12.13	6.42	12.63	7.68	–	26.44	.98	10.63	6.89	25.6	3.63	3.50	2.68	3.13	–	61.0	P464 ³⁾