

▼ From left to right: RC2510, RC53, RC1002, RC108, RC5010, RC156



- Trio Bearing system with hardened composite wear bands for optimal side load resistance
- Strengthened Trio Stop Ring improves durability and side load resistance
- Trio Hybrid pre-tensioned spring system provides faster retraction
- High-grade polyethylene seals for low wear and long service life
- Plunger wiper reduces contamination, extending cylinder life.
- Collar and plunger threads and base mounting holes enable easy fixturing (on most models)
- Standard certified lifting eyes on cylinder models above 55 lbs weight. Interchangeable with optional CHM6 carrying handle
- Designed for use in all positions
- Baked enamel finish for increased corrosion resistance
- Includes CR400 coupler, dust cap and collar thread protector
- RC-Series model numbers, external dimensions and threads remain unchanged from prior RC-Series cylinders.

▼ *Foundation repair: to re-stabilize the foundation, the 308-ton silo needed to be lifted, levelled and structurally supported. 25-ton RC-Series hydraulic jacks were attached to a bracket on the top of each steel pier. Powered by a Z-Class pump, the hydraulic jacks applied 20 tons of force at each placement to lift the silo 2.0 inches.*



The Industry Standard General Purpose Cylinder



Saddles

All RC cylinders (except RC50 and RC101) have a hardened removable grooved saddle.

For tilt and flat saddles, see the RC-Series accessory page. All CATS-Series Tilt Saddles use a nitrocarburization surface treatment for improved corrosion protection.

Page: 16



Base Plates

To ensure the stability of cylinders for lifting applications, base plates are available for 10, 25 and 50-ton RC-cylinders.

Page: 16



Specialty Attachments

For solving all kinds of application problems, specialty attachments are available for 5, 10 and 25-ton RC-cylinders.

Page: 176

▼ *Synchronous lifting set-up for 200-ton cylinders. To ensure the stability of the cylinders, JBI25 base plates are installed.*



Single-Acting, General Purpose Cylinders



Optional Carrying Handle CHM6

The standard, certified lifting eyes on cylinders weighing over 55 lbs (RC5010 and heavier models) can be interchanged with optional carrying handle **CHM6**.

▼ **QUICK SELECTION CHART** For complete technical information see next page.

Cylinder Capacity tons (maximum)	Stroke (inch)	Model Number	Cylinder Effective Area (in ²)	Oil Capacity (in ³)	Collapsed Height (inch)	 (lbs)
5 (4.9)	0.63	RC50	0.99	0.62	1.63	2.2
	1.00	RC51	0.99	0.99	4.34	2.3
	3.00	RC53	0.99	2.97	6.50	3.3
	5.00	RC55 *	0.99	4.95	8.50	4.1
	7.00	RC57	0.99	6.93	10.75	5.3
	9.13	RC59	0.99	9.04	12.75	6.1
10 (11.2)	1.00	RC101	2.24	2.24	3.53	4.0
	2.13	RC102 *	2.24	4.76	4.78	5.1
	4.13	RC104	2.24	9.23	6.75	7.2
	6.13	RC106 *	2.24	13.70	9.75	9.8
	8.00	RC108	2.24	17.88	11.75	12.0
	10.13	RC1010 *	2.24	22.64	13.75	14.0
	12.00	RC1012	2.24	26.82	15.75	15.0
	14.00	RC1014	2.24	31.29	17.75	18.0
15 (15.7)	1.00	RC151	3.14	3.14	4.88	7.2
	2.00	RC152	3.14	6.28	5.88	9.0
	4.00	RC154 *	3.14	12.57	7.88	11.0
	6.00	RC156 *	3.14	18.85	10.69	15.0
	8.00	RC158	3.14	25.13	12.69	18.0
	10.00	RC1510	3.14	31.42	14.69	21.0
	12.00	RC1512	3.14	37.70	16.69	24.0
	14.00	RC1514	3.14	43.98	18.69	26.0
25 (25.8)	1.00	RC251	5.16	5.16	5.50	13.0
	2.00	RC252 *	5.16	10.32	6.50	14.0
	4.00	RC254 *	5.16	20.64	8.50	18.0
	6.25	RC256 *	5.16	32.25	10.75	22.0
	8.25	RC258	5.16	42.56	12.75	27.0
	10.25	RC2510	5.16	52.88	14.75	31.0
	12.25	RC2512	5.16	63.20	16.75	36.0
	14.25	RC2514 *	5.16	73.52	18.75	39.0
30 (32.4)	8.25	RC308	6.49	53.56	15.25	40.0
	2.00	RC502	11.04	22.09	6.94	33.0
50 (55.2)	4.00	RC504	11.04	44.18	8.94	42.0
	6.25	RC506 *	11.04	69.03	11.13	51.0
	10.25	RC5010	11.04	113.21	15.13	70.0
	13.25	RC5013	11.04	146.34	18.13	83.0
75 (79.5)	6.13	RC756	15.90	97.49	11.25	65.0
	13.13	RC7513	15.90	208.82	19.38	130.0
100 (103.1)	2.00	RC1002	20.63	41.26	8.63	81.00
	6.63	RC1006	20.63	136.77	14.06	130.0
	10.25	RC10010	20.63	211.45	17.69	160.0

* Available as set, see note on this page.

RC-Trio Series



Capacity:
5 - 100 tons

Stroke:
0.63 - 14.25 inches

Maximum Operating Pressure:
10,000 psi



Think Safety

Manufacturer's rating of load and stroke are maximum safe limits. Good practice encourages using only 80% of these ratings.

Page: **400**



Lightweight Aluminum Cylinders

If you need a higher cylinder capacity-to-weight-ratio the **RAC-Series** are the perfect choice.

Page: **18**



Gauges

Minimize the risk of overloading and ensure long, dependable service from your equipment. Refer to the System Components

Section for a full range of gauges.

Page: **127**

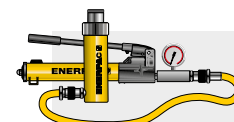

Cylinder-Pump Sets

All cylinders marked with an * are available as **sets** (cylinder, gauge, couplers, hose and pump) for your ordering convenience.

Page: **6**



Speed Chart and Pump Selection Tool

See the Enerpac Cylinder Speed Chart in our 'Yellow Pages' to determine your approximate cylinder speed. See Pump Selection Tool on website for help to choose the most suitable pump for your application.

Page: **399**

◀ For full features see previous page.

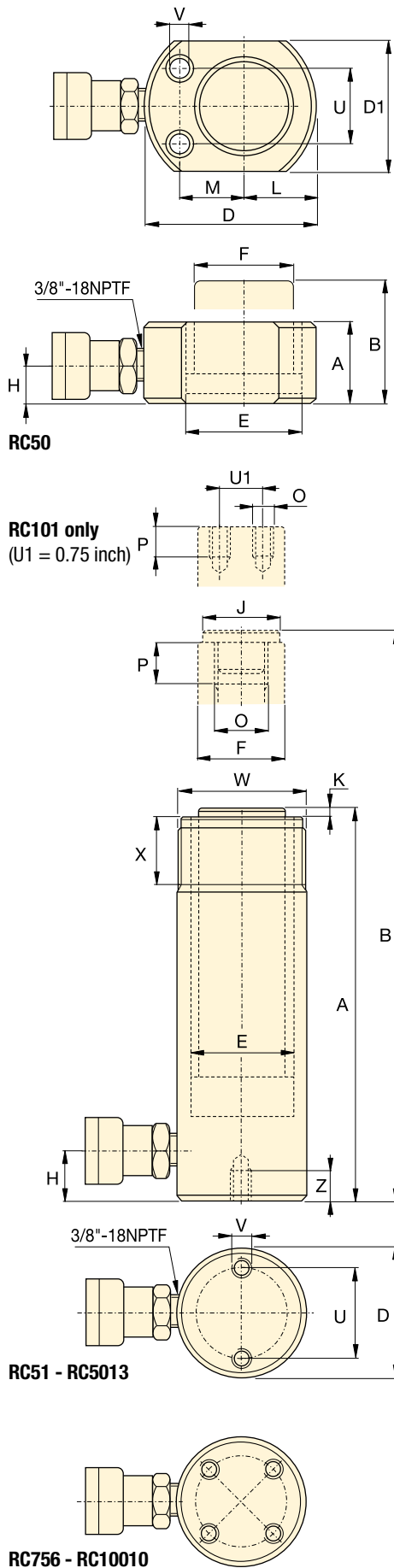

Cylinder Capacity tons (maximum)	Stroke (inch)	Model Number	Cylinder Effective Area (in ²)	Oil Capacity (in ³)	Collapsed Height A (in)	Extended Height B (in)	Outside Dia. D (in)
5 (4.9)	0.63	RC50 ²⁾	0.99	0.62	1.63	2.25	2.31 ³⁾
	1.00	RC51	0.99	0.99	4.34	5.34	1.50
	3.00	RC53	0.99	2.97	6.50	9.50	1.50
	5.00	RC55 ¹⁾	0.99	4.95	8.50	13.50	1.50
	7.00	RC57	0.99	6.93	10.75	17.75	1.50
	9.13	RC59	0.99	9.04	12.75	21.88	1.50
10 (11.2)	1.00	RC101 ⁴⁾	2.24	2.24	3.53	4.53	2.25
	2.13	RC102 ¹⁾	2.24	4.76	4.78	6.91	2.25
	4.13	RC104	2.24	9.23	6.75	10.88	2.25
	6.13	RC106 ¹⁾	2.24	13.70	9.75	15.88	2.25
	8.00	RC108	2.24	17.88	11.75	19.75	2.25
	10.13	RC1010 ¹⁾	2.24	22.64	13.75	23.88	2.25
	12.00	RC1012	2.24	26.82	15.75	27.75	2.25
	14.00	RC1014	2.24	31.29	17.75	31.75	2.25
15 (15.7)	1.00	RC151	3.14	3.14	4.88	5.88	2.75
	2.00	RC152	3.14	6.28	5.88	7.88	2.75
	4.00	RC154 ¹⁾	3.14	12.57	7.88	11.88	2.75
	6.00	RC156 ¹⁾	3.14	18.85	10.69	16.69	2.75
	8.00	RC158	3.14	25.13	12.69	20.69	2.75
	10.00	RC1510	3.14	31.42	14.69	24.69	2.75
	12.00	RC1512	3.14	37.70	16.69	28.69	2.75
	14.00	RC1514	3.14	43.98	18.69	32.69	2.75
25 (25.8)	1.00	RC251	5.16	5.16	5.50	6.50	3.38
	2.00	RC252 ¹⁾	5.16	10.32	6.50	8.50	3.38
	4.00	RC254 ¹⁾	5.16	20.64	8.50	12.50	3.38
	6.25	RC256 ¹⁾	5.16	32.25	10.75	17.00	3.38
	8.25	RC258	5.16	42.56	12.75	21.00	3.38
	10.25	RC2510	5.16	52.88	14.75	25.00	3.38
	12.25	RC2512	5.16	63.20	16.75	29.00	3.38
	14.25	RC2514 ¹⁾	5.16	73.52	18.75	33.00	3.38
30 (32.4)	8.25	RC308	6.49	53.56	15.25	23.50	4.00
	2.00	RC502	11.04	22.09	6.94	8.94	5.00
	4.00	RC504	11.04	44.18	8.94	12.94	5.00
50 (55.2)	6.25	RC506 ¹⁾	11.04	69.03	11.13	17.38	5.00
	10.25	RC5010	11.04	113.21	15.13	25.38	5.00
	13.25	RC5013	11.04	146.34	18.13	31.38	5.00
75 (79.5)	6.13	RC756	15.90	97.49	11.25	17.38	5.75
	13.13	RC7513	15.90	208.82	19.38	32.51	5.75
100 (103.1)	2.00	RC1002	20.63	41.26	8.63	10.63	7.00
	6.63	RC1006	20.63	136.77	14.06	20.69	7.00
	10.25	RC10010	20.63	211.45	17.69	27.94	7.00

¹⁾ Available as set, see note on pages 6 - 13.

²⁾ RC50 cylinder has a non-removable grooved saddle and no collar thread.

³⁾ RC50: D1 = 1.63 inch, L = 0.81 inch, M = 1.00 inch.

⁴⁾ RC101 has plunger with two thread holes and non-removable saddle.

Single-Acting, General Purpose Cylinders

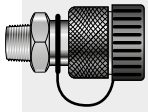

Coupler Included!

CR400 coupler included on all models. Fits all HC-Series hoses.

Capacity:

5 - 100 tons

Stroke:

0.63 - 14.25 inches

Maximum Operating Pressure:

10,000 psi

RC-Trio Series



Cylinder Bore Dia. E (in)	Plunger Dia. F (in)	Base to Adv. Port H (in)	Saddle Dia. J (in)	Saddle Protr. from Plgr. K (in)	Plunger Internal Thread O (in)	Plunger Thread Length P (in)	Base Mounting Holes			Collar Thread W (in)	Collar Thread Length X (in)	Weight (lbs)	Model Number
							Bolt Circle U (in)	Thread V (in)	Thd. Depth Z (in)				
1.13	1.00	0.75	2)	2)	2)	2)	1.13	0.22	—	—	—	2.2	RC50 ²⁾
1.13	1.00	0.75	1.00	0.25	3/4" - 16 UN	0.56	1.00	1/4" - 20 UNC	0.56	1 1/2" - 16 UN	1.13	2.3	RC51
1.13	1.00	0.75	1.00	0.25	3/4" - 16 UN	0.56	1.00	1/4" - 20 UNC	0.56	1 1/2" - 16 UN	1.13	3.3	RC53
1.13	1.00	0.75	1.00	0.25	3/4" - 16 UN	0.56	1.00	1/4" - 20 UNC	0.56	1 1/2" - 16 UN	1.13	4.1	RC55 ¹⁾
1.13	1.00	0.75	1.00	0.25	3/4" - 16 UN	0.63	1.00	1/4" - 20 UNC	0.56	1 1/2" - 16 UN	1.13	5.3	RC57
1.13	1.00	0.75	1.00	0.25	3/4" - 16 UN	0.63	1.00	1/4" - 20 UNC	0.56	1 1/2" - 16 UN	1.13	6.1	RC59
1.69	1.50	0.75	—	—	#10 - 24 UN	0.25	1.56	5/16" - 18 UNC	0.50	2 1/4" - 14 UN	1.06	4.0	RC101 ⁴⁾
1.69	1.50	0.75	1.38	0.25	1" - 8 UN	0.75	1.56	5/16" - 18 UNC	0.50	2 1/4" - 14 UN	1.13	5.1	RC102 ¹⁾
1.69	1.50	0.75	1.38	0.25	1" - 8 UN	0.75	1.56	5/16" - 18 UNC	0.50	2 1/4" - 14 UN	1.06	7.2	RC104
1.69	1.50	0.75	1.38	0.25	1" - 8 UN	0.75	1.56	5/16" - 18 UNC	0.50	2 1/4" - 14 UN	1.13	9.8	RC106 ¹⁾
1.69	1.50	0.75	1.38	0.25	1" - 8 UN	0.75	1.56	5/16" - 18 UNC	0.50	2 1/4" - 14 UN	1.06	12	RC108
1.69	1.50	0.75	1.38	0.25	1" - 8 UN	0.75	1.56	5/16" - 18 UNC	0.50	2 1/4" - 14 UN	1.13	14	RC1010 ¹⁾
1.69	1.50	0.75	1.38	0.25	1" - 8 UN	0.75	1.56	5/16" - 18 UNC	0.50	2 1/4" - 14 UN	1.06	15	RC1012
1.69	1.50	0.75	1.38	0.25	1" - 8 UN	0.75	1.56	5/16" - 18 UNC	0.50	2 1/4" - 14 UN	1.06	18	RC1014
2.00	1.63	0.75	1.50	0.38	1" - 8 UN	1.00	1.88	3/8" - 16 UNC	0.50	2 3/4" - 16 UN	1.19	7.2	RC151
2.00	1.63	0.75	1.50	0.38	1" - 8 UN	1.00	1.88	3/8" - 16 UNC	0.50	2 3/4" - 16 UN	1.19	9	RC152
2.00	1.63	0.75	1.50	0.38	1" - 8 UN	1.00	1.88	3/8" - 16 UNC	0.50	2 3/4" - 16 UN	1.19	11	RC154 ¹⁾
2.00	1.63	1.00	1.50	0.38	1" - 8 UN	1.00	1.88	3/8" - 16 UNC	0.50	2 3/4" - 16 UN	1.19	15	RC156 ¹⁾
2.00	1.63	1.00	1.50	0.38	1" - 8 UN	1.00	1.88	3/8" - 16 UNC	0.50	2 3/4" - 16 UN	1.19	18	RC158
2.00	1.63	1.00	1.50	0.38	1" - 8 UN	1.00	1.88	3/8" - 16 UNC	0.50	2 3/4" - 16 UN	1.19	21	RC1510
2.00	1.63	1.00	1.50	0.38	1" - 8 UN	1.00	1.88	3/8" - 16 UNC	0.50	2 3/4" - 16 UN	1.19	24	RC1512
2.00	1.63	1.00	1.50	0.38	1" - 8 UN	1.00	1.88	3/8" - 16 UNC	0.50	2 3/4" - 16 UN	1.19	26	RC1514
2.56	2.25	1.00	2.00	0.41	1 1/2" - 16 UN	1.00	2.31	1/2" - 13 UNC	0.75	3 5/16" - 12 UN	1.94	13	RC251
2.56	2.25	1.00	2.00	0.41	1 1/2" - 16 UN	1.00	2.31	1/2" - 13 UNC	0.75	3 5/16" - 12 UN	1.94	14	RC252 ¹⁾
2.56	2.25	1.00	2.00	0.41	1 1/2" - 16 UN	1.00	2.31	1/2" - 13 UNC	0.75	3 5/16" - 12 UN	1.94	18	RC254 ¹⁾
2.56	2.25	1.00	2.00	0.41	1 1/2" - 16 UN	1.00	2.31	1/2" - 13 UNC	0.75	3 5/16" - 12 UN	1.94	22	RC256 ¹⁾
2.56	2.25	1.00	2.00	0.41	1 1/2" - 16 UN	1.00	2.31	1/2" - 13 UNC	0.75	3 5/16" - 12 UN	1.94	27	RC258
2.56	2.25	1.00	2.00	0.41	1 1/2" - 16 UN	1.00	2.31	1/2" - 13 UNC	0.75	3 5/16" - 12 UN	1.94	31	RC2510
2.56	2.25	1.00	2.00	0.41	1 1/2" - 16 UN	1.00	2.31	1/2" - 13 UNC	0.75	3 5/16" - 12 UN	1.94	36	RC2512
2.56	2.25	1.00	2.00	0.41	1 1/2" - 16 UN	1.00	2.31	1/2" - 13 UNC	0.75	3 5/16" - 12 UN	1.94	39	RC2514 ¹⁾
2.88	2.25	1.13	2.00	0.41	1 1/2" - 16 UN	1.00	2.31	1/2" - 13 UNC	0.63	3 5/16" - 12 UN	1.94	40	RC308
3.75	3.13	1.31	2.81	0.11	—	—	3.75	1/2" - 13 UNC	0.75	5" - 12 UN	2.19	33	RC502
3.75	3.13	1.31	2.81	0.11	—	—	3.75	1/2" - 13 UNC	0.75	5" - 12 UN	2.19	42	RC504
3.75	3.13	1.38	2.81	0.11	—	—	3.75	1/2" - 13 UNC	0.75	5" - 12 UN	2.19	51	RC506 ¹⁾
3.75	3.13	1.38	2.81	0.11	—	—	3.75	1/2" - 13 UNC	0.75	5" - 12 UN	2.19	70	RC5010
3.75	3.13	1.38	2.81	0.11	—	—	3.75	1/2" - 13 UNC	0.75	5" - 12 UN	2.19	83	RC5013
4.50	3.75	1.19	2.81	0.11	—	—	4.50	5/8" - 13 UNC	0.63	5 3/4" - 12 UN	1.75	65	RC756
4.50	3.75	1.19	2.81	0.11	—	—	4.50	5/8" - 13 UNC	0.63	5 3/4" - 12 UN	1.75	130	RC7513
5.13	4.13	1.63	2.81	0.11	—	—	5.50	3/4" - 10 UNC	1.00	6 7/8" - 12 UN	1.75	81	RC1002
5.13	4.13	1.63	2.81	0.11	—	—	5.50	3/4" - 10 UNC	1.00	6 7/8" - 12 UN	1.75	130	RC1006
5.13	4.13	1.63	2.81	0.11	—	—	5.50	3/4" - 10 UNC	1.00	6 7/8" - 12 UN	1.75	160	RC10010

▼ SELECTION CHART

For use with Cylinder Capacity (tons)	Saddles			Base Plate	Mounting Block	Clevis Eyes	
	Flat	Grooved ¹⁾	Tilt			Base ⁴⁾	Plunger
5	A53F ²⁾	A53G ²⁾	–	–	RB5 ²⁾ , AW51 ²⁾ , AW53 ²⁾	REB5 ²⁾	REP5 ²⁾
10	A12 ⁵⁾ , A102F ³⁾	A102G ³⁾	CATS12 ³⁾	JB110 ³⁾	RB10, AW102	REB10	REP10 ³⁾
15	–	A152G	CATS12	–	RB15	REB15	REP10
25	A29 ⁵⁾	A252G	CATS52	JB125	RB25	REB25	REP25
30	A29 ⁵⁾	A252G	CATS52	–	RB25	–	REP25
50	–	–	CATS100	JB150	–	–	–
75	–	–	CATS100	–	–	–	–
100	–	–	CATS100	–	–	–	–

¹⁾ Standard on 5-30 tons RC-cylinders ²⁾ Except RC50 ³⁾ Except RC101 ⁴⁾ Mounting screws are included. ⁵⁾ Used with Bender Sets.

▼ DIMENSION CHARTS

Model Number	Saddle Dimensions (in)			A53F, A102F A12, A29	For Cylinder Capacity (tons)	Tilt Saddle Model Number	Addition to Collapsed Height A1 (in)	Saddle Diameter J1 (in)	
	A	B	C						
	Flat								
A53F	1.00	0.25	0.68		10	CATS12	0.55	1.38	
A102F	1.38	0.24	0.88		15	CATS12	0.43	1.38	
A12	2.00	1.88	1" - 8 UNC		25	CATS52	0.59	1.97	
A29	2.00	1.88	1½" - 16 UNC		30	CATS52	0.59	1.97	
	Grooved				50	CATS100	0.59	2.80	
A53G	1.00	0.25	0.68		75	CATS100	0.59	2.80	
A102G	1.38	0.24	0.88		100	CATS100	0.59	2.80	
A152G	1.50	0.37	0.88						
A252G	1.97	0.37	1.40						

Model Number	Base Plate Dimensions (in)					 JBI10, 25	 JBI50
	A	B	C	D	E		
JB110	9.00	9.00	5.34	2.29	0.81		
JB125	11.00	11.00	5.53	3.41	1.03		
JB150	12.00	0.60	3.75	5.19	1.25		

Model Number	Mounting Block Dimensions (in)								 RB5, -10 RB15, -25	 AW51	 AW53	 AW102 (l=1.19)
	A	B	C	D	E	F	G	H				
RB5	1½" - 16UN	3.50	3.00	–	1.00	–	–	–				
AW51	1½" - 16UN	2.76	2.36	0.43	0.98	2.13	¼" - 16 UN	1.62				
AW53	1½" - 16UN	2.87	0.28	0.31	0.75	2.25	¼" - 20 UN	0.41				
RB10	2¼" - 14UN	4.50	3.50	–	1.00	–	–	–				
AW102	2¼" - 14UN	3.94	3.25	0.63	1.18	3.00	7/16" - 20 UN	2.31				
RB15	2¾" - 16UN	4.00	4.50	–	1.50	–	–	–				
RB25	3¾" - 12UN	5.00	6.50	–	2.00	–	–	–				

Type	Model Number	Clevis Eye Dimensions (in)						Pin-to-Pin * (in)	 REB	 REP
		A	B	C	D	E	F			
Base ⁴⁾	REB5	1.75	1.88	0.56	0.63	0.63	1.00	2.37		
	REB10	2.50	2.63	1.00	0.88	1.00	1.38	3.07		
	REB15	3.00	2.63	1.00	0.88	1.00	1.38	3.07		
	REB25	3.75	3.13	1.50	1.25	1.25	1.63	3.45		
Plunger	REP5	1.13	1.75	0.56	0.63	0.63	0.75	–		
	REP10	1.69	2.43	1.00	0.88	1.00	1.13	–		
	REP25	2.25	2.81	1.50	1.25	1.25	1.38	–		

⁴⁾ Mounting screws are included.

* Pin to Pin – REB and REP Clevises fitted. Add cylinder collapsed height.