

# Type 75A Water Pressure Regulator

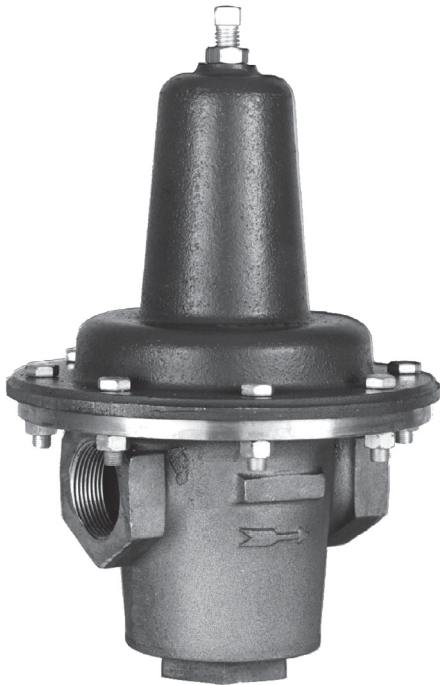

W2248

EXTERIOR

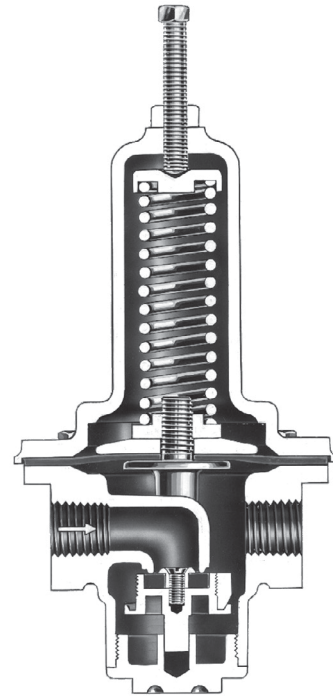

W0057

SECTIONAL VIEW  
FOR NPS 1/2, 3/4, 1, AND 1-1/2  
(DN 15, 20, 25, AND 40) BODIES

**Figure 1.** Type 75A Regulator

## Introduction

The Type 75A regulator is designed to reduce domestic or industrial water pressure, thus protecting plumbing fixtures and meters from high-pressure surges. The Type 75A is self-contained, requiring no external control line for operation.

Downstream pressure is directly registered under the diaphragm. As the downstream pressure increases, the diaphragm force overcomes the spring

compression, causes the valve disk to rise, and reduces flow through the regulator.

If the downstream pressure decreases, the spring force pushes the valve yoke and disk down to open the body port. This permits increased flow and increases outlet pressure to the desired level. The spring for each regulator allows operation over an outlet pressure range of 20 to 80 psig (1,4 to 5,5 bar). The outlet pressure setting is easily changed by turning the adjusting screw.



# Bulletin 71.1:75A

## Specifications

### Body Size

NPS 1/2, 3/4, 1, and 1-1/2 (DN 15, 20, 25, and 40)  
with integral cast seats  
NPS 2 and 2-1/2 (DN 50 and 65) with  
threaded-in seats

### Maximum Inlet Pressure<sup>(1)</sup>

200 psig (13,8 bar)

### Outlet Pressure Ranges

20 to 80 psig (1,4 to 5,5 bar)

### Maximum Allowable Outlet Pressure<sup>(1)</sup>

10% above spring setting, or 5 psig (0,34 bar)  
above setting, whichever is greater

### Minimum Operating Differential<sup>(1)</sup>

5 psi (0,34 bar)

### Maximum Operating Temperature<sup>(1)</sup>

-20° to 150°F (-29° to 66°C)

### Construction Materials

**Body:** Bronze

**Spring Case:** Cast iron

**Threaded-in Orifice (NPS 2 and 2-1/2  
(DN 50 and 65) units only):** Bronze

**Valve Disk and Holder:** Nitrile (NBR) and bronze

**Diaphragm:** Nitrile (NBR)

1. The pressure/temperature limits in this bulletin or any applicable standard limitation should not be exceeded.

**Table 1. Capacity Chart for Type 75A Regulator**

BODY SIZE, NPS (DN)	CAPACITIES IN GPM (l/min) OF WATER				WIDE-OPEN C <sub>v</sub> FOR RELIEF SIZING
	Droop, PSIG (bar)				
	5 (0,34)	7 (0,48) <sup>(1)</sup>	10 (0,69)	15 (1,0)	
1/2 (15)	8 (30,3)	10 (37,9)	14 (53,0)	19 (71,9)	4.3
3/4 (20)	16 (60,6)	20 (75,7)	28 (106)	40 (151)	8.4
1 (25)	25 (94,6)	33 (125)	45 (170)	60 (227)	13.5
1-1/2 (40)	50 (189)	65 (246)	85 (322)	115 (435)	28.0
2 (50)	75 (284)	95 (360)	125 (473)	175 (662)	39.0
2-1/2 (65)	115 (435)	140 (530)	185 (700)	260 (984)	64.0
1. The 7 psig (0,48 bar) offset pressure and the related capacities are considered the upper limits of flows consistent with good piping practices and maximum fluid velocities of 10 feet per second (3,05 m/s).					

1. The 7 psig (0,48 bar) offset pressure and the related capacities are considered the upper limits of flows consistent with good piping practices and maximum fluid velocities of 10 feet per second (3,05 m/s).

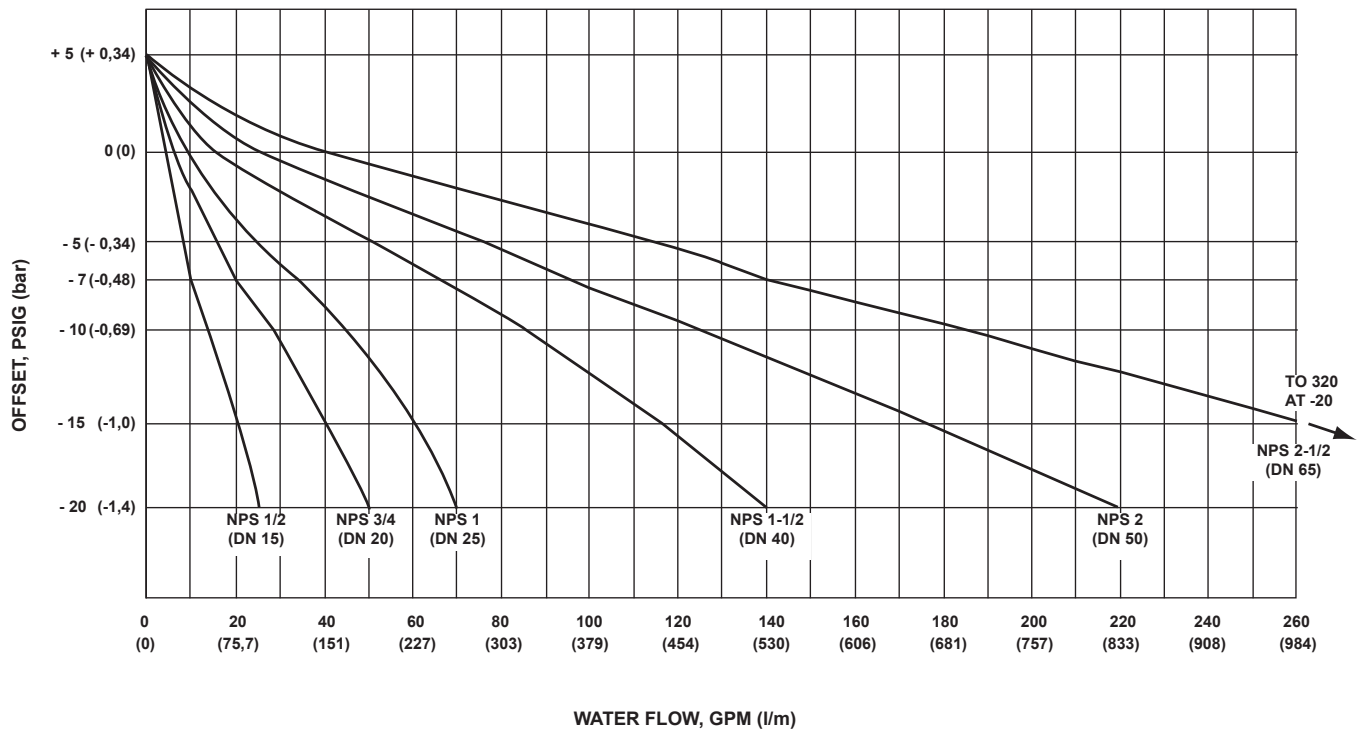

Figure 2. Type 75A Sizing Curves

## Overpressure Protection

As is the case with most regulators, Type 75A has maximum inlet pressure ratings which exceed the outlet pressure ratings. Overpressuring any regulating equipment may be hazardous. If actual inlet pressure can exceed the outlet pressure ratings, some type of overpressure protection is needed.

## Sizing Information

Flow capacity and the maximum permissible offset pressure that the system can tolerate determine the correct regulator size for your application. Consult the Type 75A Sizing Curves (Figure 2) and the Capacity Chart (Table 1) to size the regulator. Several choices may provide the required flow rate.

For example, if desired water flow is 30 GPM (114 l/m), the first intersecting curve (Figure 2) is that of the NPS 3/4 (DN 20) regulator. At that point, offset is 11 psi (0,76 bar), which is outside the limits of good piping practice. Moving upward again, the next intersecting curve is that of the NPS 1 (DN 25) regulator. Here, offset is 6 psi (0,41 bar). This rating is permissible and the NPS 1 (DN 25) regulator is acceptable.

## Ordering Information

In order to prevent delays in order processing, please specify type numbers and regulator size clearly.

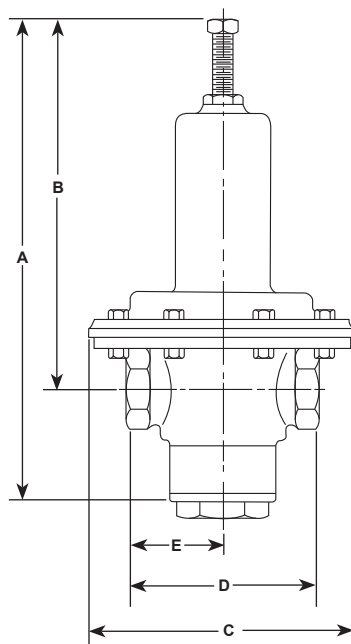

BODY SIZE, NPS (DN)	DIMENSIONS, INCHES (mm)				
	A	B	C	D	E
1/2 (15)	9.75 (248)	7.12 (181)	4.31 (109)	3.75 (95)	1.88 (48)
3/4 (20)	11.25 (286)	8.38 (213)	5.44 (138)	4.25 (108)	2.12 (54)
1 (25)	12.25 (311)	9.12 (232)	6.62 (168)	4.75 (121)	2.38 (60)
1-1/2 (40)	13.62 (346)	9.88 (251)	8.19 (208)	5.88 (149)	2.94 (75)
2 (50)	18.62 (473)	13.88 (353)	9.38 (238)	6.38 (162)	3.19 (81)
2-1/2 (65)	19.12 (486)	14.12 (359)	9.38 (238)	7.75 (197)	3.88 (99)

**Figure 3. Dimensions**

## Industrial Regulators

### Emerson Process Management Regulator Technologies, Inc.

USA - Headquarters  
McKinney, Texas 75069-1872 USA  
Tel: 1-800-558-5853  
Outside U.S. 1-972-548-3574

Asia-Pacific  
Shanghai, China 201206  
Tel: +86 21 2892 9000

Europe  
Bologna, Italy 40013  
Tel: +39 051 4190611

Middle East and Africa  
Dubai, United Arab Emirates  
Tel: +971 4811 8100

## Natural Gas Technologies

### Emerson Process Management Regulator Technologies, Inc.

USA - Headquarters  
McKinney, Texas 75069-1872 USA  
Tel: 1-800-558-5853  
Outside U.S. 1-972-548-3574

Asia-Pacific  
Singapore, Singapore 128461  
Tel: +65 6777 8211

Europe  
Bologna, Italy 40013  
Tel: +39 051 4190611  
Gallardon, France 28320  
Tel: +33 (0)2 37 33 47 00

## TESCOM

### Emerson Process Management Tescom Corporation

USA - Headquarters  
Elk River, Minnesota 55330-2445 USA  
Tel: 1-763-241-3238

Europe  
Selmsdorf, Germany 23923  
Tel: +49 (0) 38823 31 0

For further information visit [www.emersonprocess.com/regulators](http://www.emersonprocess.com/regulators)

The Emerson logo is a trademark and service mark of Emerson Electric Co. All other marks are the property of their prospective owners. Fisher is a mark owned by Fisher Controls, Inc., a business of Emerson Process Management.

*The contents of this publication are presented for informational purposes only, and while every effort has been made to ensure their accuracy, they are not to be construed as warranties or guarantees, express or implied, regarding the products or services described herein or their use or applicability. We reserve the right to modify or improve the designs or specifications of such products at any time without notice.*

Emerson Process Management does not assume responsibility for the selection, use or maintenance of any product. Responsibility for proper selection, use and maintenance of any Emerson Process Management product remains solely with the purchaser.