

# SA1000



## Flow sensor

SAM16BBD100G/W/US

Article no longer available - archive entry

Alternative article: SA5000 When selecting an alternative article and accessories please note that technical data may differ! –  
When selecting an alternative article and accessories please note that technical data may differ! – Discontinuation date: 31.03.2016

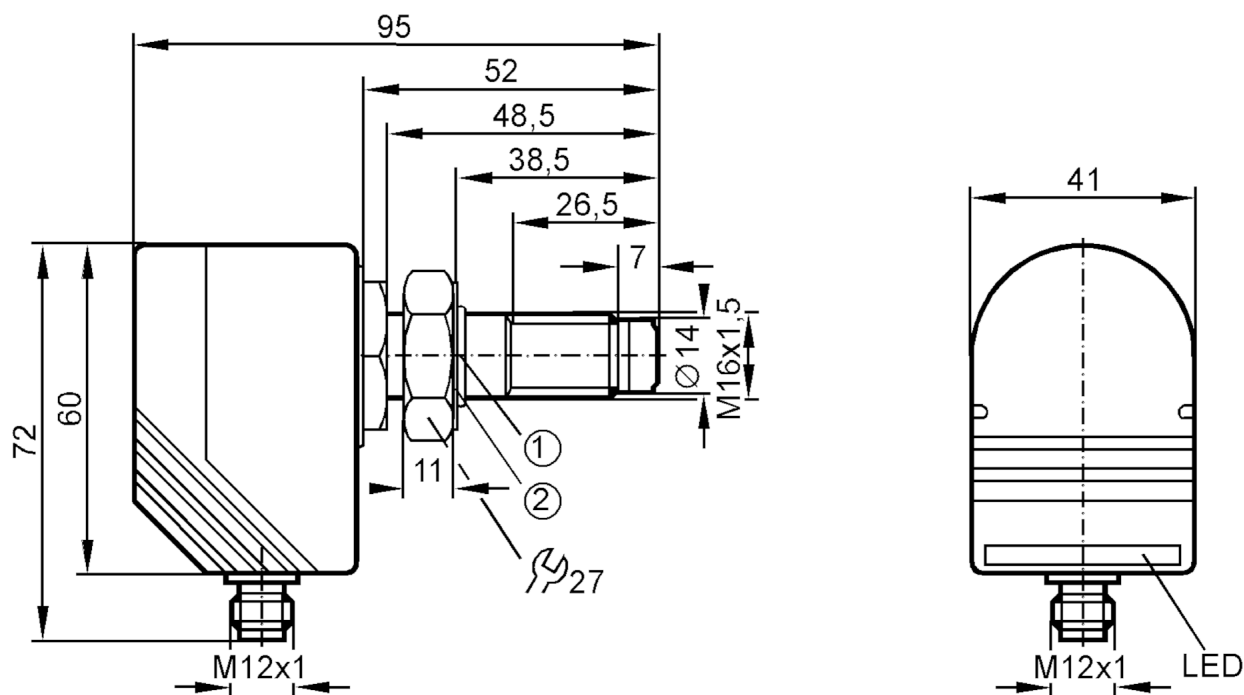

- 1 O-ring  
2 compression washer



### Product characteristics

Process connection M16 x 1,5

### Application

Design for pipes DN 40...DN 100

Media water

Note on media  
Clean water without contamination and additives.  
Dirt/build-up on the sensor tip affects the measurement accuracy.  
Check the sensor tip for build-up from time to time.  
If necessary, clean with a soft cloth and a vinegar cleansing agent.

Medium temperature [°C] 0...80

Pressure rating [bar] 30

### Electrical data

Operating voltage [V] 20...28 DC; (according to EN 50178 SELV/PELV)

Current consumption [mA] < 80

Reverse polarity protection yes

Power-on delay time [s] 15

# SA1000



## Flow sensor

SAM16BBD100G/W/US

Outputs		
Output signal		analogue signal
Analogue current output	[mA]	4...20; (linearised)
Max. load	[Ω]	500
Analogue voltage output	[V]	; (linearised)
Short-circuit protection		no
Overload protection		yes
Measuring/setting range		
Flow range	[cm/s]	3...150
Accuracy / deviations		
Note on repeatability		7 (v < 150 cm/s), 3 (v < 50 cm/s)
Temperature gradient	[K/min]	200
Measuring error		max. ± 10
	[% of the final value]	
Response times		
Response time	[s]	5; (10%...90%)
Operating conditions		
Ambient temperature	[°C]	-20...60
Protection		IP 67
Tests / approvals		
MTTF	[years]	389
Mechanical data		
Weight	[g]	268.8
Dimensions	[mm]	M16 x 1.5
Thread designation		M16 x 1.5
Materials		PBT-GF20
Materials (wetted parts)		stainless steel (1.4404 / 316L); stainless steel (1.4571/316Ti ); O-ring: NBR 70 Shore A
Process connection		M16 x 1,5
Displays / operating elements		
Display	function	10 x LED, green Resolution 10 % of the final value
Remarks		
Notes		discontinued article
Pack quantity		1 pcs.
Electrical connection		
Connector: 1 x M12		

# SA1000

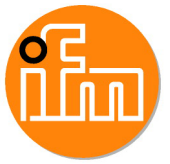

## Flow sensor

SAM16BBD100G/W/US

### Connection

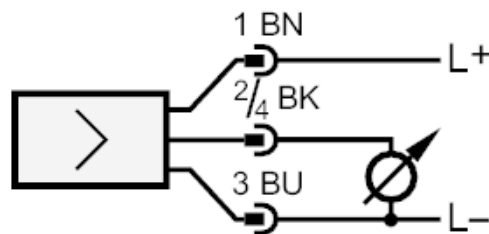

Core colours :

BN =	brown
BU =	blue
BK =	black
WH =	white

Article no longer available - archive entry

Alternative article: SA5000 When selecting an alternative article and accessories please note that technical data may differ! –  
When selecting an alternative article and accessories please note that technical data may differ! – Discontinuation date: 31.03.2016