

## CUSTOM SOLENOIDS & ACTUATORS

Kendrion Mishawaka

### Dual Solenoid Valve Actuator

The Dual Solenoid Valve Actuator is used in beverage dispensers. Due to the wish of the customer a mistake-proof connector was included to prevent operators from wiring the solenoid incorrectly. The mounting features are integrated in the design resulting in the reduction of the part count, thus easing the overall assembly of the component. Another feature is a groove on the armature holding a rubber o-ring which reduces the clicking noise while switching. The electromagnetic actuator has a cycle life of 750,000-plus cycles and operates with a voltage of 24V DC. With the quieter operation and the easy maintenance both customer and the operator experience was improved.

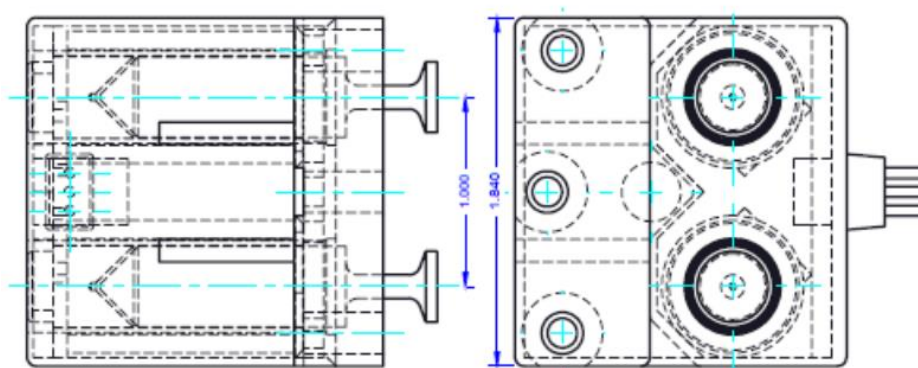
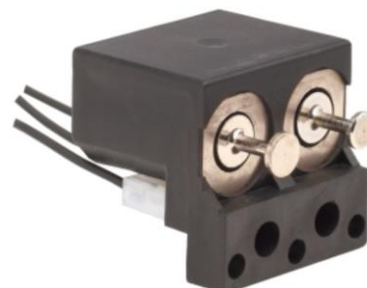

#### Technical Specification

Media	Syrup and water
Stroke	0.150"
Voltage	24V DC
Materials and Finish	6/12 Nylon / 12L14 steel
Package Size (H/D/W)	1.8"/1.7"/1.9"
Cycle Life	750K + Cycles
Applications/Comments	Beverage Dispenser

2015-08-05