

# COCAM wt880

## Code Camera for Barcode Reading



- Code camera with WVGA sensor
- Industrial design with compact shape
- Reads all standard 1D and 2D barcodes including PHARMA-CODE™
- Suited for all applications and marking methods
- Code reading in standstill or motion up to 3 m/sec
- Automatic focus setting
- Barcode quality test in line with ISO/IEC 15415 and ISO/IEC 15416 as well as AIM DPM (Direct Part Marking) guideline
- Alignment aid (laser)

Outstanding sensitivity for many printing inks through bicoloured LED illumination. High scanning output with integrated evaluation of the code data.

Integrated ethernet interface for very simple integration into the Laetus ARGUS wt system.

Setup assistant for fast and efficient alignment. Rotatable plug unit for multisided installation. High industry standard protection category.

Technical Features	Description		
Reading distance	100 mm	80 mm	45 mm
Reading area	67 x 43 mm	54 x 34 mm	32 x 21 mm
Depth of focus	55 mm at 0.25 mm module width	40 mm at 0.25 mm module width	To be determined
Sensor	Global shutter CMOS WVGA (752 x 480 Pixel)		
Lighting	Red / blue LED switchable in combination		
Symbologies	EAN/UPC, Code 39, Code32, Code 2/5 Interleaved, Code 128, GS1-128, Codabar, PDF417, Datamatrix ECC200, GS1-Datamatrix, PHARMA-CODE™ GS1 Data Bar, QR Code intended		
Decoding rate	25 Hz (Data Matrix)		
Defect pattern memory	10 images		
Voltage supply	24 V DC		
Operating temperature	0 ... 40°C		
Power connector	17 pin. M12 male connector Operating voltage 2 x 24 V signal inputs 2 x 24 V signal outputs (opto-isolated), 2 optional via adapter box External illumination trigger output		
Ethernet connector	4 pin. M12 female connector Ethernet interface for device configuration (web technology)		
Housing	Zinc diecasting, lacquered		
Protection grade	IP 65		

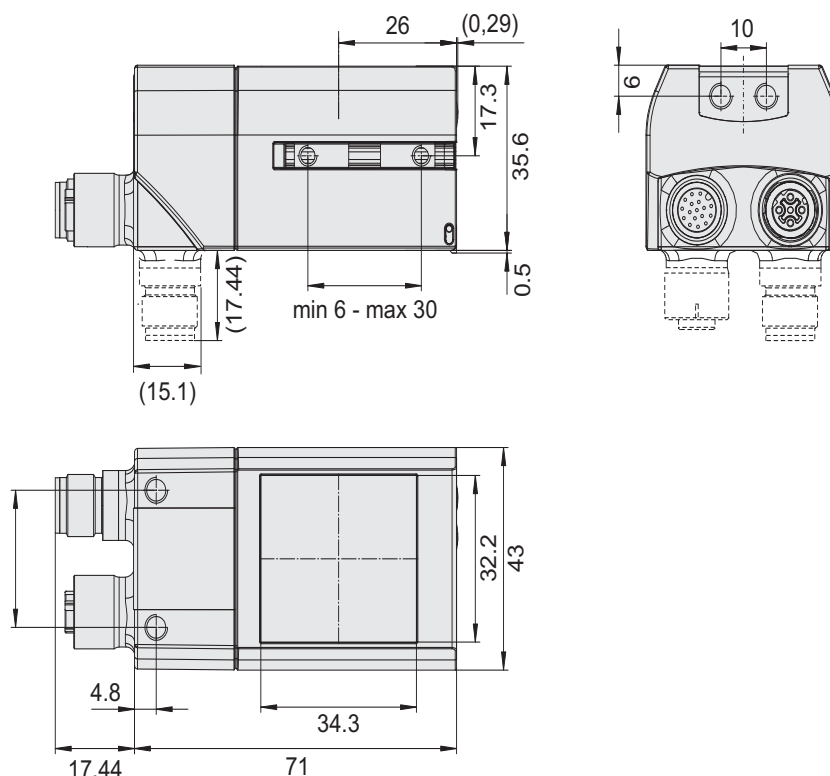

Information may be subject to modification without prior consent or notification.