

## Product Information TFP-47, -57, -67, -167

## FOOD

# Temperature Sensor Tri-Clamp

## Application/Specified usage

- Temperature Measurement in vessels and pipes

## Application examples

- Monitoring of CIP-/SIP-process
- Temperature monitoring in milk vessels

## Hygienic design/Process connection

- Tri-Clamp sealing system without adapter
- Product contacting materials compliant to FDA
- Sensor completely made of stainless steel
- Conforming to 3-A Sanitary Standard 74-06

## Features/Advantages

- Direct Connection without adapter
- Integrated transmitter optional
- Different electrical connections available

## Options/Accessories

- 2 x Pt100 (not retrofittable)
- 2 x Pt100 with two transmitters (not retrofittable)
- Pt100 chip with other classes of accuracy (1/3B, 1/10B)
- Programmable transmitters with output 4...20 mA, 2-wire
- Programming adapter MPU-P 9701
- Integrated transmitters for HART-protocol
- Integrated transmitter MPU-LCD with display in connecting head
- Fast response sensor tip 3 mm and 4 mm
- Pre-assembled connecting cable in other lengths and other material

## Authorizations



## Temperature sensor TFP-47



# Temperature Transmitter MPU-LCD with Display

## Application / Specified Usage

- 4...20mA transmitter with LCD for Pt100 temperature sensor
- For installation in temperature sensor
- Sensor monitoring

## Features

- 4-digit display with green backlight
- Temperature measurement in °C and °F
- Easy range select by one button
- Lower costs for wiring because of 2-wire technology

## Note

See product information „MPU-LCD“ for details.



## Option MPU-LCD (display in the connection head)



Temperature sensor		
Process connection		Tri-Clamp
Materials	connecting head thermowell and Tri-Clamp	stainless steel 1.4301 (AISI 304) stainless steel 1.4404 (AISI 316L)
Surface quality		$R_a \leq 0.8 \mu\text{m}$
Insertion length EL		20...500 mm in steps of 5 mm
Operating pressure		10 bar maximum
Temperature ranges	ambient process CIP-/ SIP-cleaning	-50...+80 °C -50...+250 °C 150 °C max. for 120 minutes (with transmitter)
Sensing resistor	acc. to DIN EN 60751	Pt100
Electrical connection	cable gland cable connection	M16 x 1.5 M12 plug 1.4301 (AISI 304), 4-pins
Protection class	cable gland cable connection	IP 67 IP 69 K

Transmitter MPU-4, MPU-H, MPU-M		
Temperature ranges	ambient storage	-40...+85 °C -55...+90 °C
Measuring ranges	MPU-4, MPU-H, MPU-M	standard: -10...40 °C, 0...50 / 100 / 150 / 200 °C special ranges free programmable
Accuracy	input	$< \pm 0.25 \text{ °C}$
Temperature drift	zero, span	$< 0.01 \% / \text{K}$
Supply	MPU-4, MPU-H, MPU-M accuracy	8...35 V DC 0.01 % / V (reference: 12 V DC)
Output	signal accuracy burden	analog 4...20 mA $< \pm 0.1 \%$ of measurement range $< 600 \Omega$ (at $U_B = 24 \text{ V}$ )
Humidity	without condensation	0...98 %

Accuracy classes of temperature sensors   Tolerances for Pt100 acc. to DIN EN 60751			
Pt100	A	1/3 B	1/10 B
0 °C / 100 $\Omega$	$\pm 0,15 \text{ K} / \pm 0,06 \Omega$	$\pm 0,10 \text{ K} / \pm 0,04 \Omega$	$\pm 0,03 \text{ K} / \pm 0,01 \Omega$
100 °C / 138,5 $\Omega$	$\pm 0,35 \text{ K} / \pm 0,13 \Omega$	$\pm 0,27 \text{ K} / \pm 0,10 \Omega$	$\pm 0,08 \text{ K} / \pm 0,03 \Omega$

## Electrical connection without transmitter

## With 1 x M12 plug

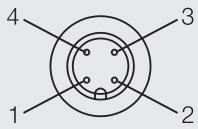

## Configuration 1st M12 plug

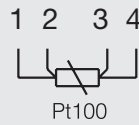

## Electrical connection with transmitter

## With M12 plug

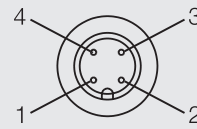

## Configuration M12 plug

- 1: + supply
- 2: - supply 4...20 mA
- 3: not connected
- 4: not connected

## With 2 x M12 plug

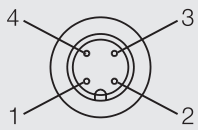

## Configuration 2nd M12 plug

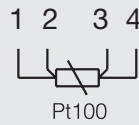

## With cable gland

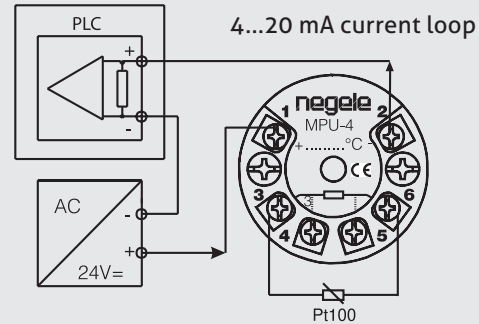

## With cable gland

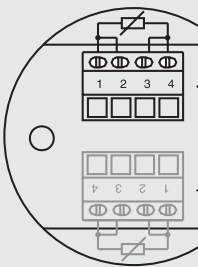

## Configuration strip terminal

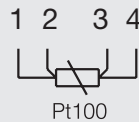

- clamps for 1st Pt100
- clamps for 2nd Pt100  
(at version 2 x Pt100)

## Electrical connection with two transmitter (TFP-67)

## With 1 x M12 plug (sensor 1 + sensor 2)

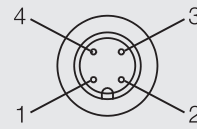

## Configuration M12 plug

- 1: + supply (sensor 1)
- 2: - supply 4...20 mA (sensor 1)
- 3: - supply 4...20 mA (sensor 2)
- 4: + supply (sensor 2)

## With 2 x M12 plug (sensor 1)

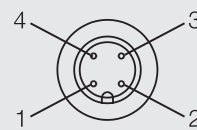

## Configuration M12 plug

- 1: + supply (sensor 1)
- 2: - supply 4...20 mA (sensor 1)
- 3: not connected
- 4: not connected

## With 2 x M12 plug (sensor 2)

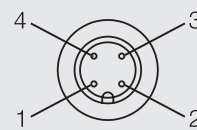

## Configuration M12 plug

- 1: + supply (sensor 2)
- 2: - supply 4...20 mA (sensor 2)
- 3: not connected
- 4: not connected

TFP-47 | TFP-47.2

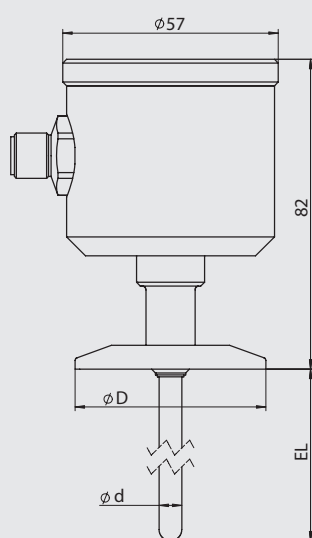

TFP-67

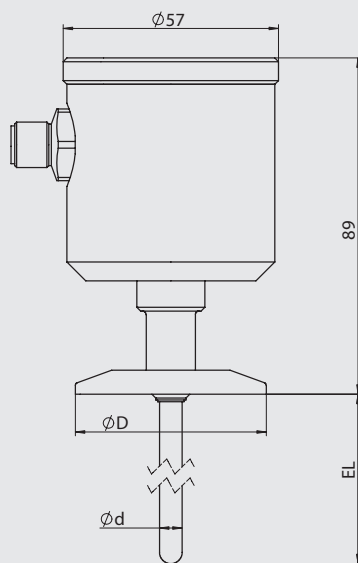

TFP-57 | TFP-57.2

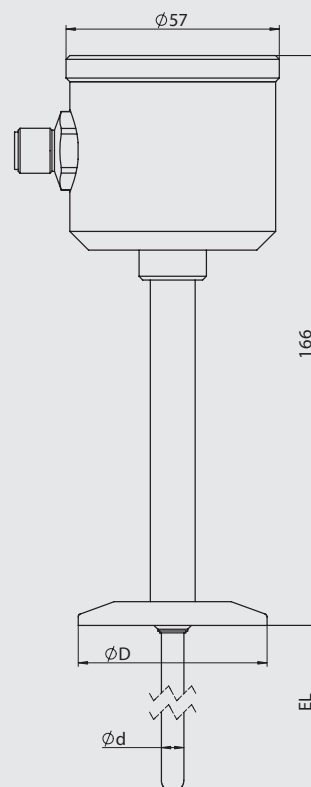

TFP-167

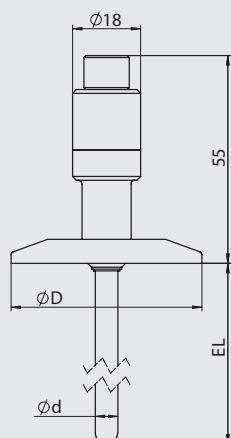

TFP-167 / ... / MPU-M

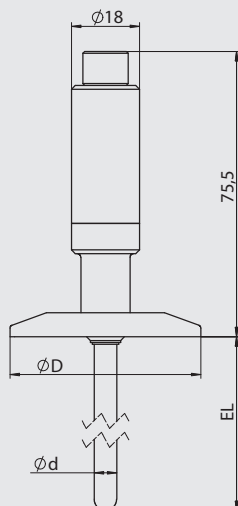

Dimension table Tri-Clamp

Type	Order code	Clamp size D [mm]	Suitable for pipe diameter	Pipe style
C25	TFP-.../C25	25.0	DN 6...8 ISO 6...10 1/4", 3/8", 1/2", 3/4"	DIN 11866 series A DIN 11866 series B / ISO 1127 DIN 11866 series C
C34	TFP-.../C34	34.0	DN 10...20	DIN 11866 series A
C50	TFP-.../C50	50.5	DN 25...40 ISO 15...25 1" + 1½"	DIN 11866 series A DIN 11866 series B / ISO 1127 DIN 11866 series C
C64	TFP-.../C64	64.0	DN 50 2"	DIN 11866 series A DIN 11866 series C
C77	TFP-.../C77	77.5	2½"	DIN 11866 series C
C91	TFP-.../C91	91.0	DN 65 3"	DIN 11866 series A DIN 11866 series C

### Sensor tip diameter and response time

All temperature sensors are available with smaller sensor tips, to ensure a shorter response time. The below-mentioned times were measured by immersing a temperature sensor from room temperature into boiling water.

#### Sensor tip Ø 6 mm

50 %-time:  $t_{50} \leq 3.0 \text{ s}$   
90 %-time:  $t_{90} \leq 8.0 \text{ s}$

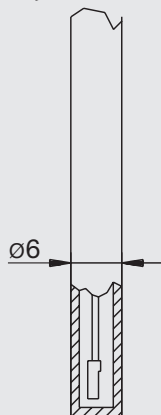

#### Sensor tip Ø 4 mm

50 %-time:  $t_{50} \leq 2.4 \text{ s}$   
90 %-time:  $t_{90} \leq 6.5 \text{ s}$

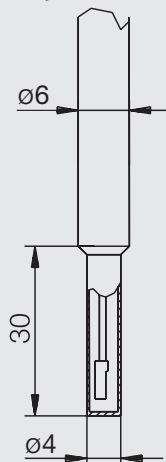

#### Sensor tip Ø 3 mm

50 %-time:  $t_{50} \leq 0.5 \text{ s}$   
90 %-time:  $t_{90} \leq 1.5 \text{ s}$

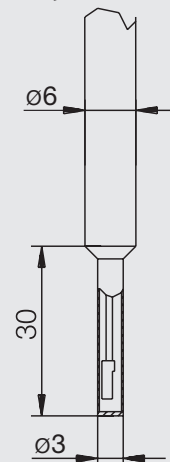

### Accessories | Spare parts

Diameter pipe		Clamp size D [mm] (see page 4)			
DIN 11866 series A	DIN 11866 series C		Clamp ring Tri-Clamp	Sealing ring Tri-Clamp	
DN10		34.0	SRC-10	DRC-10	
DN15		34.0	SRC-10	DRC-15	
DN20		34.0	SRC-10	DRC-20	
DN25		50.5	SRC-25	DRC-25	
DN32		50.5	SRC-25	DRC-32	
DN40		50.5	SRC-25	DRC-40	
DN50		64.0	SRC-50	DRC-50	
DN65		9.0	SRC-65	DRC-65	
	1/2"	25.0	SRC-5	DRC-1/2"	
	3/4"	25.0	SRC-5	DRC-3/4"	
	1"	50.5	SRC-25	DRC-1"	
	2"	64.0	SRC-50	DRC-50	
	2½"	77.5	SRC-2½"	DRC-2½"	
	3"	91.0	SRC-65	DRC-65	

**Conditions for a measuring point according to 3-A Sanitary Standard 74-06**

- The sensors TFP-47, -57, -67, -167 conforming to the 3-A Sanitary Standard.
- The sensors are designed for CIP-/ SIP-cleaning. Maximum 150 °C / 120 min.
- Only with 3-A conforming Tri-Clamp connection.
- Mounting position, self draining and the position of the leakage hole must be in accordance to current 3-A Sanitary Standard.

**Transport / Storage**

- No outdoor storage
- Dry and dust free
- Not exposed to corrosive media
- Protected against solar radiation
- Avoiding mechanical shock and vibration
- Storage temperature -55...+90 °C
- Relative humidity maximum 98 %

**Cleaning / Maintenance**

- In case of using pressure washers, don't point nozzle directly to electrical connections!

**Disposal**

- Electrical devices should not be disposed of with household trash. They must be recycled in accordance with national laws and regulations.
- Take the device directly to a specialized recycling company and do not use municipal collection points.

**Conventional Usage**

- Not suitable for applications in explosive areas.
- Not suitable for applications in security-relevant equipments (SIL).

**Reshipment**

- Sensors shall be clean and free of media or heat-conductive paste and must not be contaminated with dangerous media!
- Use suitable transport packaging only to avoid damage of the equipment!

**Standards and Guidelines**

- You have to comply with applicable regulations and directives.

**Note on CE**

- Applicable directives:  
Electromagnetic Compatibility Directive 2014/30/EU
- Compliance with the applicable EU directives is identified by the CE label on the product.
- The operating company is responsible for complying with the guidelines applicable to the entire installation.

**Accessories**

**PVC-cable with M12-connection made of 1.4305, IP 69 K, unshielded**

M12-PVC / 4-5 m	PVC-cable 4-pin, length 5 m
M12-PVC / 4-10 m	PVC-cable 4-pin, length 10 m
M12-PVC / 4-25 m	PVC-cable 4-pin, length 25 m

**PVC-cable with M12-connection, brass nickel-plated, IP 67, shielded**

M12-PVC / 4G-5 m	PVC-cable 4-pin, length 5 m
M12-PVC / 4G-10 m	PVC-cable 4-pin, length 10 m
M12-PVC / 4G-25 m	PVC-cable 4-pin, length 25 m

**Programming adapter  
MPU-P 9701**

Programming adapter for  
MPU-4, MPU-H and MPU-M

**PVC-cable with M12-connection****Programming adapter MPU-P 9701**

## Order code for version with 1 x Pt100

TFP-47 (connecting head Ø 57 mm)

TFP-57 (connecting head Ø 57 mm, with spacer)

TFP-167 (connecting head Ø 18 mm, electrical connection via M12 plug)

## Sensor length EL in mm

020...500 (in steps of 5 mm)

xxx (special length)

## Diameter thermowell in mm

6

8

## Diameter sensor tip in mm

X (no reduction)

3 (only for thermowell 6 mm)

4 (only for thermowell 6 mm and 8 mm)

6 (only for thermowell 8 mm)

## Accuracy class Pt100

A

1/3B

1/10B

## Electrical connection (not selectable for TFP-167)

PG (cable gland M16x1.5)

M12 (M12 plug, standard with MPU-LCD)

## Transmitter

X (without)

## only for TFP-47, -57

MPU-4 (programmable)

MPU-H (HART-protocol)

MPU-LCD (with display)

## only for TFP-167

MPU-M (programmable)

## Measuring range MPU

(only for types with transmitter; not for MPU-LCD)

-10...40 (measurement range -10...40 °C)

0...50 (measurement range 0...+50 °C)

0...100 (measurement range 0...+100 °C)

0...150 (measurement range 0...+150 °C)

0...200 (measurement range 0...+200 °C)

xx...yy (special range)

## Tri-Clamp size

C25 (Pipe diameter: see "Dimension

C34 Table Tri-Clamp" on page 4)

C50

C64

C77

C91

TFP-47/ 100/ 6/ X/ A/ PG/ MPU-4/ 0...100/ C25

## Order code for version with 2 x Pt100

**TFP-47.2** (connecting head Ø 57 mm, 2 x Pt100, no transmitter possible)  
**TFP-57.2** (connecting head Ø 57 mm, 2 x Pt100, with spacer, no transmitter possible!)  
**TFP-67** (high connecting head Ø 57 mm, 2 x Pt100, prepared for 2 x transmitter)

## Sensor length EL in mm

**020...500** (in steps of 5 mm)  
**xxx** (special length)

## Diameter thermowell in mm

**6**  
**8**

## Diameter sensor tip in mm

**X** (no reduction)  
**3** (only for thermowell 6 mm)  
**4** (only for thermowell 6 mm and 8 mm)  
**6** (only for thermowell 8 mm)

## Accuracy class Pt100

**A**  
**1/3B**  
**1/10B**

## Electrical connection (only for TFP-47.2 and 57.2)

**PG** (cable gland M16x1.5)  
**2PG** (2 x cable gland M16x1.5)  
**2M12** (2 x M12 plug)

## Electrical connection (only for TFP-67)

**M12** (M12 plug)  
**2M12** (2 x M12 plug)

## 1st Transmitter

**MPU-4** (programmable)

## Measuring range 1st transmitter

**-10...40** (measurement range -10...40 °C)  
**0...50** (measurement range 0...+50 °C)  
**0...100** (measurement range 0...+100 °C)  
**0...150** (measurement range 0...+150 °C)  
**0...200** (measurement range 0...+200 °C)  
**xx...yy** (special range)

## 2nd Transmitter

**MPU-4** (programmable)

## Measuring range 2nd transmitter

**-10...40** (range -10...40 °C)  
**0...50** (range 0...+50 °C)  
**0...100** (range 0...+100 °C)  
**0...150** (range 0...+150 °C)  
**0...200** (range 0...+200 °C)  
**xx...yy** (special range)

## Tri-Clamp size

**C25** (Pipe diameter:  
**C34** see "Dimension  
**C50** table Tri-Clamp" on  
**C64** page 4)  
**C77**  
**C91**

**TFP-67/ 100/ 6/ X/ A/ M12/ MPU-4/ 0...100/ MPU-4/ 0...100/ C25**