

Pneumatically Operated Valve DN 8 - 20 mm (3/8" - 3/4")



Cf. 1, 2 & 3



Cf. 4 & 5

Butt weld ends
MA 10
Fold out page 21

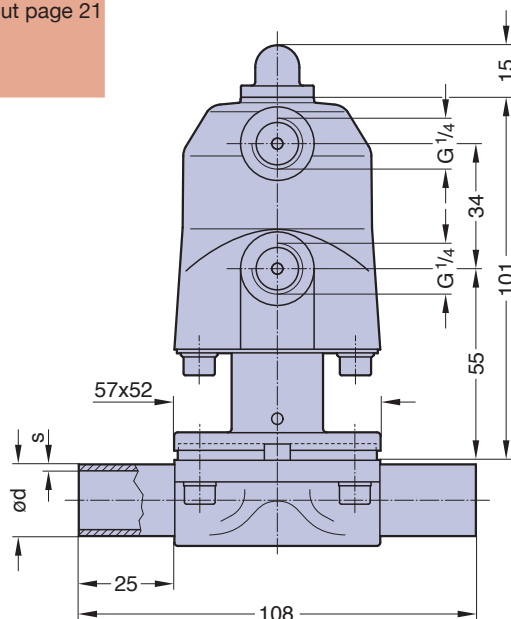

Features

- Efficient plastic piston actuator with stainless steel distance piece
- Control air connection 90° to flow direction
- Flexible diaphragm suspension
- Encapsulated diaphragm
- Optical indicator
- Compact design, the outside diameter of the actuator is the same size as the bonnet flange
- CDSA sealing concept, see page 32

Optional

- Available with a wide range of control equipment and accessories see page 118 to 125, also for retrofitting
- Control air connection in flow direction

Technical Data

- Control function (Cf.): Pneumatically operated
 Fail safe close (NC): Cf. 1 & 4
 Fail safe open (NO): Cf. 2 & 5
 Double acting (DA): Cf. 3
- Direction:
 Control connection: At Cf. 1, 2 & 3, 90° to flow direction, standard
 Max. working pressure: Unidirectional (delta p = 100%)
 EPDM diaphragm 8 bar (115 psi)
 PTFE diaphragm 7 bar (100 psi)

Higher working pressure may be achieved with different actuator. Please consult a SED factory representative for working pressure above the indicated maximum.

- Max. working temperature: 160°C (320°F) dependent on application
- Control pressure:
 Cf. 1 4,2 - 7 bar (60 - 100 psi)
 Cf. 2, 3 4 - 5 bar (60 - 72 psi)
- Diaphragm material: EPDM or PTFE
 Valve body material: Forged 1.4435/ 316 L ASME/BPE
 Investment cast 1.4435/ 316 L
 Other alloys
- End connection:
 Butt weld ends see fold out page 21
 Clamps and flanges see page 22 and 23
 Special ends
- Actuators suitable for:
 Two-Way bodies
 Welded configurations
 T-bodies
 Multiport bodies
 Tank bottom bodies
- Flow rate: Kv in m³/h (Cv in GPM) see page 9
 Diaphragm size: MA 10
 Weight: ca. 0,8 kg
 Technical data also valid for multiport valve.

DN (mm)	MA	Filling volume (NL)	
		NC	NO/DA
8-20	10	0,027	0,027

Valve type overview see page 26 and 27.
 Ordering key see page 59 to 61.