



TSURUMI PUMP

U 3-phase
50Hz

Sewage pump with vortex impeller

The U pump features a vortex (eddy flow) structure and wide pump casing interior, preventing clogging by waste and solid matter.





Vortex Impeller







This impeller is used mainly to avoid clogging or wear by large or stringy solids in the water. It accelerates part of the water to great speed, and this speed is used to smoothly move all the water from inlet to outlet.

Optional Accessories:

- TOK4-A guide rail fitting for small pumps:
 - Guide support / Guide hook
 - Duck foot bend
 - Lifting chain



Specifications:

	Model		Colour code curve		Bore mm	Power output kW	Phases	r.p.m.	Head max. m	Capacity max. l/min	Starting method	Dry weight kg without cable		Impeller passage mm
	free standing	with guide rail fitting										free standing	with guide rail fitting	
autom.	40UA2.25	optional		1	40	0,25	3	2850	7,4	264	direct	14,5	-	35
	50UA2.4	optional		2	50	0,4	3	2850	11,0	270	direct	20,0	-	35
	50UA2.75	optional		3	50	0,75	3	2850	15,0	270	direct	24,0	-	35
manual	80U2.75	TOS80U2.75		4	80	0,75	3	2850	12,2	450	direct	29,0	24,0	46
	80U21.5	TOS80U21.5		5	80	1,5	3	2850	16,5	600	direct	40,0	36,0	46
	80U22.2	TOS80U22.2		6	80	2,2	3	2850	19,0	800	direct	55,0	51,0	56
	80U23.7	TOS80U23.7		7	80	3,7	3	2850	23,5	1030	direct	62,0	58,0	56

ø Discharge bore mm			50mm, 80mm
Pumping Fluid	Temperature		0-40°C
	Type of Fluid		Municipal sewage, water with solids
Pump	Compo-nents	Impeller	Vortex impeller
		Shaft Seal	Double mechanical seal
		Bearings	Shielded ball bearings
	Material	Impeller	Grey iron casting EN-GJL-200
		Casing	Grey iron casting EN-GJL-200
		Shaft Seal	Silicon carbide in oil bath
Motor	Phase / Voltage		3-phase / 400V / 50Hz / d.o.l.
	Insulation		Insulation class E, Insulation class F
	Motor Protector (built-in)		Circle thermal cut-out
	Lubrication		Turbine oil (ISO VG32)
	Type, Poles		Induction motor, 2 poles, IP68
	Material	Casing	Grey iron casting EN-GJL-150
Shaft		Stainless steel EN-X6Cr13, Stainless	
Cable		Rubber, NSSHÖU	
Discharge Connection			Inside thread, JIS10K flange
Optional Accessories			Guide rail fitting "TOK" for small pu duck foot bend, lifting chain) / Bend

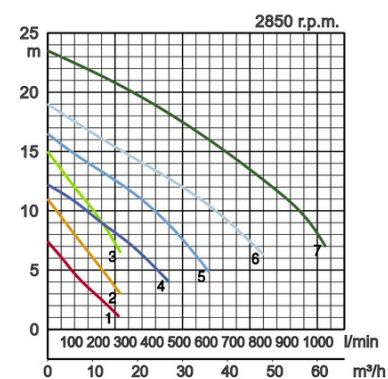

Dimensions in mm:

Model	A	A4	B	D	FL1	FL2	H	W1	W2
40UA2.25	241	207	107	194	100	585	433	-	-
50UA2.4	236	199	102	187	105	590	450	-	-
50UA2.75	383	246	102	172	105	590	475	-	-
80U2.75	383	329	173	172	-	-	421	130	385
80U21.5	420	366	173	200	-	-	501	135	430
80U22.2	502	410	225	240	-	-	562	160	490
80U23.7	502	410	226	234	-	-	565	160	520

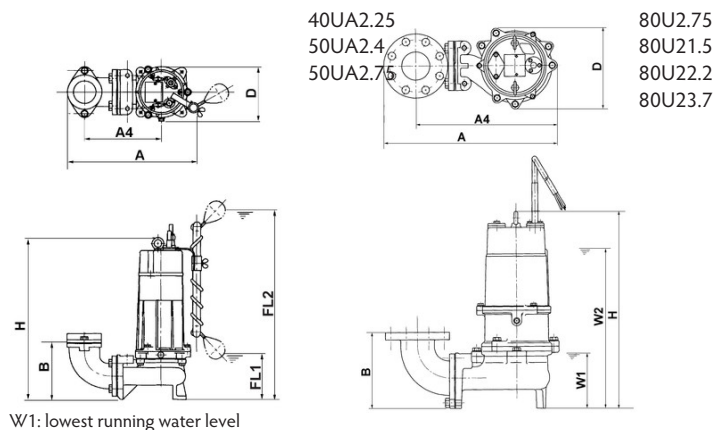

Model	A	A5	D	H	H1	W1	W2
40UA2.25	-	-	-	-	-	-	-
50UA2.4	-	-	-	-	-	-	-
50UA2.75	-	-	-	-	-	-	-
80U2.75	347	130	172	523	710	230	490
80U21.5	389	130	200	603	-	240	530
80U22.2	418	130	240	647	-	245	575
80U23.7	418	130	234	650	895	245	610

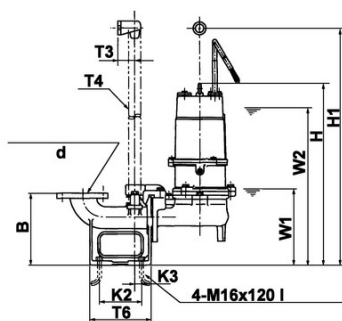
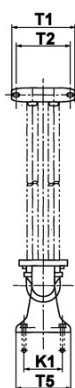
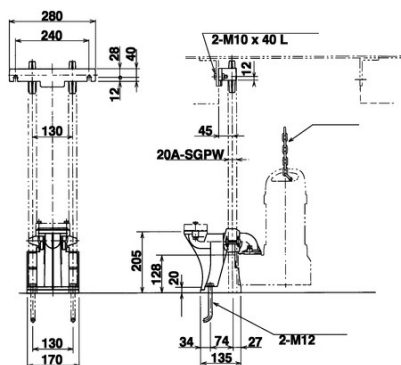
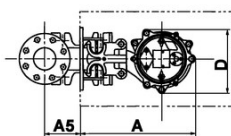
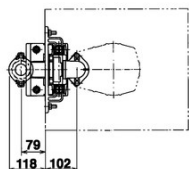

Dischcharge bore mmd	T1	T2	T3	T4	T5	T6	K1	K2	K3	B1	
80mm	80	230	195	60	32	190	220	140	140	15	270

Wahlerstr. 10
D-40472 Düsseldorf
Tel.: +49 (0)211-4179373
Fax: +49 (0)211-417937-480
Email: sales@tsurumi.eu
www.tsurumi.eu

We reserve the right to change specifications and designs herein for improvement without prior notice. Our pumps are for professional use only. In the event that Tsurumi (Europe) GmbH have, in exceptional cases taken over, a manufacturer's warranty, this entitles the enduser to assert remedy free of charge against Tsurumi (Europe) GmbH due to any defect to the product occurring during the guarantee period (see below), also then when the warranty claims against the seller do not or no longer exist. In the event of malfunction, which is attributable to the improper handling by the enduser, no guarantee claim arise. Further claims shall not result from the warranty, unless if something to the contrary has explicitly been determined. The decision as to whether remedy is effected by way of replacement or repair shall be at the choice of Tsurumi (Europe) GmbH. The claims shall be time barred after a period of three months after expiry of the guarantee period, however, not before expiry of the warranty period which is valid towards the seller. In the event of doubt, the warranty period shall correspond with the warranty period which is valid between the end-user and his seller.

sew-U-EN

